

PNI H-Light 6060, 48W

PNI H-Light 1230, 48W

LED ceiling panel light

BG.	LED лампа за таванни панели
DE.	LED Deckenpannelleuchte
ES.	Panel de luz LED para techo
FR.	Panneau lumineux de plafond à LED
HU.	LED mennyezeti panel lámpa
IT.	Pannello luminoso a LED per soffitto
NL.	LED plafondpaneel licht
PL.	Oświetlenie sufitowe LED
RO.	Panou LED pentru tavan

Contents

English	3
Български	6
Deutsch	9
Español	12
Français	15
Magyar	18
Italiano	21
Nederlands	24
Polski	27
Romana	30

Technical specifications

	PNI-HL6060	PNI-HL1230
Input voltage	220 - 240 V AC 50/60 Hz	220 - 240 V AC 50/60 Hz
Power	48 W	
Color temperature	6400 K	
Beam angle	120°	
Luminous flux	110 lm/W	
CRI	80 Ra	
Dimensions	595 x 595 x 32 mm	295 x 1195 x 32 mm
Protection grade	IP20	
Operating temperature	-26° ~ 80°C	
Lifespan	up to 20000 hours	
Number of on/off	up to 15000	

Safety warnings

Turn off the mains power before installing the LED ceiling

light.

Do not connect the LED ceiling light to a voltage other than the recommended one (220-240 VAC).

Electrical connections must only be made by a licensed electrician.

Never disassemble the LED ceiling light. In case of failure, contact a specialized center.

LEDs cannot be replaced. Replace the product when the LEDs have reached the maximum life limit.

Mount the LED ceiling light only indoors.

Installation

Turn off the main power supply before installing the LED ceiling light.

Remove a panel from the drop ceiling where you will mount the LED panel.

Connect the LED panel to the 230V power source.

Fix the LED panel to the drop ceiling structure.

Turn on the main power supply again.

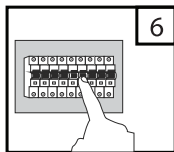
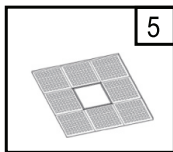
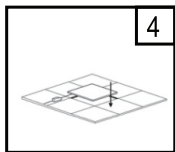
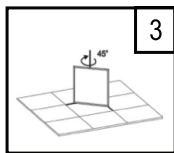
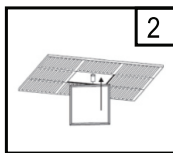
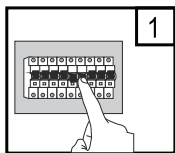

Declaration of conformity

ONLINESHOP SRL declares that the LED Ceiling Light PNI H-Light 6060 / PNI H-Light 1230 is in compliance with the EMC Directive 2014/30/EU. The full text of the EU declaration of conformity is available at the following internet address:

<https://www.mypni.eu/products/10499/download/certifications>

Технически спецификации

	PNI-HL6060	PNI-HL1230
Входно напрежение	220 - 240 V AC 50/60 Hz	220 - 240 V AC 50/60 Hz
Мощност	48 W	
Цветна температура	6400 K	
Ъгъл на лъча	120°	
Светлинен поток	110 lm/W	
CRI	80 Ra	
Размери	595 x 595 x 32 mm	295 x 1195 x 32 mm
Степен на защита	IP20	
Работна температура	-26° ~ 80°C	
Продължителност на живота	до 20000 часа	
Брой вкл./изкл	до 15000	

Предупреждения за безопасност

Изключете електрическата мрежа, преди да инсталирате LED плафона.

Не свързвайте LED плафона към напрежение, различно от препоръчаното (220-240 VAC).

Електрическите връзки трябва да се извършват само от лицензиран електротехник.

Никога не разглобявайте LED плафона. В случай на повреда, свържете се със специализиран център.

Светодиодите не могат да се сменят. Сменете продукта, когато светодиодите достигнат максималния срок на живот.

Монтирайте LED таванното осветление само на закрито.

Инсталация

Изключете основното захранване, преди да инсталирате LED таванното осветление.

Отстранете панел от окачения таван, където ще монтирате LED панела.

Свържете LED панела към източник на захранване 230V.

Фиксирайте LED панела към конструкцията на окачения таван.

Включете отново основното захранване.

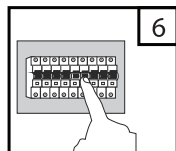
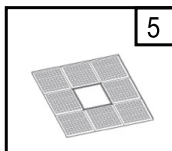
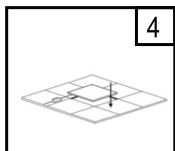
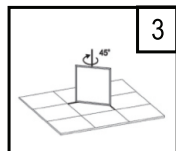
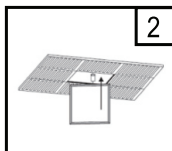
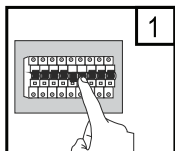

Декларация за съответствие

ONLINESHOP SRL декларира, че LED лампата за таван PNI H-Light 6060 / PNI H-Light 1230 е в съответствие с EMC Директива 2014/30/EU. Пълният текст на ЕС декларацията за съответствие е достъпен на следния интернет адрес: <https://www.mypni.eu/products/10499/download/certifications>

Technische Spezifikationen

	PNI-HL6060	PNI-HL1230
Eingangsspannung	220 - 240 V AC 50/60 Hz	220 - 240 V AC 50/60 Hz
Leistung	48 W	
Farbtemperatur	6400 K	
Abstrahlwinkel	120°	
Lichtstrom	110 lm/W	
CRI	80 Ra	
Abmessungen	595 x 595 x 32 mm	295 x 1195 x 32 mm
Schutzart	IP20	
Betriebstemperatur	-26° ~ 80°C	
Lebensdauer	bis zu 20000 Stunden	
Anzahl der Ein-/ Aus-Schalter	bis zu 15000	

Sicherheitswarnungen

Schalten Sie die Netzstromversorgung aus, bevor Sie die

LED-Deckenleuchte installieren.

Schließen Sie die LED-Deckenleuchte nicht an eine andere als die empfohlene Spannung (220-240 VAC) an.

Elektrische Anschlüsse dürfen nur von einem zugelassenen Elektriker vorgenommen werden.

Zerlegen Sie die LED-Deckenleuchte niemals. Wenden Sie sich im Störfall an ein Fachzentrum.

LEDs können nicht ausgetauscht werden. Ersetzen Sie das Produkt, wenn die LEDs die maximale Lebensdauer erreicht haben.

Montieren Sie die LED-Deckenleuchte nur im Innenbereich.

Installation

Schalten Sie die Hauptstromversorgung aus, bevor Sie die LED-Deckenleuchte installieren.

Entfernen Sie eine Platte von der Zwischendecke, an der Sie die LED-Platte montieren möchten.

Schließen Sie die LED-Platte an die 230-V-Stromquelle an.

Befestigen Sie die LED-Platte an der Zwischendeckenkonstruktion.

Schalten Sie die Hauptstromversorgung wieder ein.

Starten Sie die Netzstromversorgung neu.

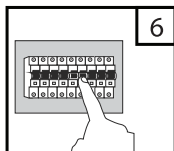
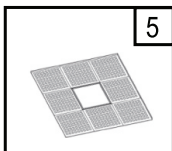
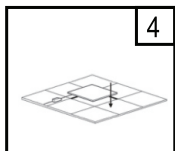
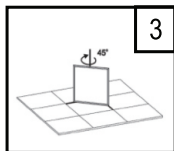
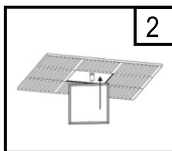
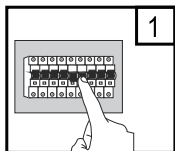

Konformitätserklärung

ONLINESHOP SRL erklärt, dass die LED-Deckenleuchte PNI H-Light 6060 / PNI H-Light 1230 der EMV-Richtlinie 2014/30/EU entspricht. Der vollständige Text der EU-Konformitätserklärung ist unter der folgenden Internetadresse verfügbar:

<https://www.mypni.eu/products/10499/download/certifications>

Especificaciones técnicas

	PNI-HL6060	PNI-HL1230
Voltaje de entrada	220 - 240 V AC 50/60 Hz	220 - 240 V AC 50/60 Hz
Potencia	48 W	
Temperatura de color	6400 K	
Ángulo de apertura del haz	120°	
Flujo luminoso	110 lm/W	
CRI	80 Ra	
Dimensiones	595 x 595 x 32 mm	295 x 1195 x 32 mm
Grado de protección	IP20	
Temperatura de funcionamiento	-26° ~ 80°C	
Vida útil	hasta 20000 horas	
Número de on/off	hasta 15000	

Advertencias de seguridad

Apague la alimentación principal antes de instalar la lámpara de techo LED.

No conecte el plafón LED a un voltaje diferente al recomendado (220-240 VAC).

Las conexiones eléctricas sólo deben ser realizadas por un electricista autorizado.

Nunca desmonte la lámpara de techo LED. En caso de avería contactar con un centro especializado.

Los LED no se pueden reemplazar. Reemplace el producto cuando los LED hayan alcanzado el límite máximo de vida útil.

Monte la lámpara de techo LED únicamente en interiores.

Instalación

Apague la fuente de alimentación principal antes de instalar la luz LED de techo.

Retire un panel del falso techo donde montará el panel LED.

Conecte el panel LED a la fuente de alimentación de 230 V.

Fije el panel LED a la estructura del falso techo.

Encienda nuevamente la fuente de alimentación principal.

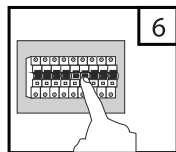
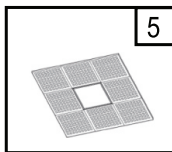
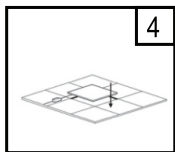
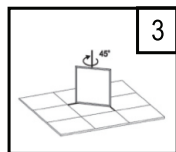
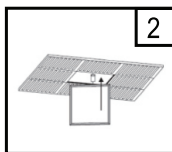
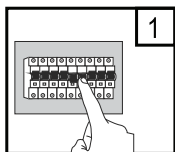

Declaración de conformidad

ONLINESHOP SRL declara que el Plafón LED PNI H-Light 6060 / PNI H-Light 1230 cumple con la Directiva EMC 2014/30/UE. El texto completo de la declaración UE de conformidad está disponible en la siguiente dirección de Internet: <https://www.mypni.eu/products/10499/download/certifications>

Spécifications techniques

	PNI-HL6060	PNI-HL1230
Tension d'entrée	220 - 240 V AC 50/60 Hz	220 - 240 V AC 50/60 Hz
Puissance	48 W	
Température de couleur	6400 K	
Angle de faisceau	120°	
Flux lumineux	110 lm/W	
IRC	80 Ra	
Dimensions	595 x 595 x 32 mm	295 x 1195 x 32 mm
Indice de protection	IP20	
Température de fonctionnement	-26° ~ 80°C	
Durée de vie	jusqu'à 20 000 heures	
Nombre d'allumages/ extinctions	jusqu'à 15 000	

Avertissements de sécurité

Coupez l'alimentation secteur avant d'installer le plafonnier LED.

Ne connectez pas le plafonnier LED à une tension autre que celle recommandée (220-240 VAC).

Les branchements électriques doivent être effectués uniquement par un électricien agréé.

Ne démontez jamais le plafonnier LED. En cas de panne, contactez un centre spécialisé.

Les LED ne peuvent pas être remplacées. Remplacez le produit lorsque les LED ont atteint leur limite de durée de vie maximale.

Montez le plafonnier LED uniquement à l'intérieur.

Installation

Coupez l'alimentation électrique principale avant d'installer le plafonnier LED.

Retirez un panneau du faux plafond où vous allez monter le panneau LED.

Connectez le panneau LED à la source d'alimentation 230V.

Fixez le panneau LED à la structure du faux plafond.

Remettez l'alimentation électrique principale sous tension.

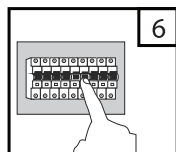
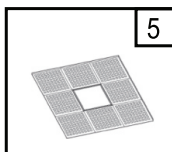
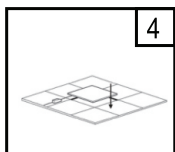
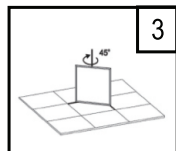
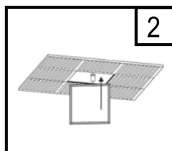
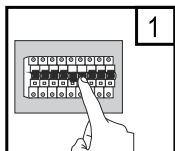

Déclaration de conformité

ONLINESHOP SRL déclare que le plafonnier LED PNI H-Light 6060 / PNI H-Light 1230 est conforme à la directive EMC 2014/30/UE. Le texte intégral de la déclaration UE de conformité est disponible à l'adresse Internet suivante:

<https://www.mypni.eu/products/10499/download/certifications>

Műszaki adatok

	PNI-HL6060	PNI-HL1230
Bemeneti feszültség	220 - 240 V AC 50/60 Hz	220 - 240 V AC 50/60 Hz
Hatalom	48 W	
Színhőmérséklet	6400 K	
Nyalábszög	120°	
Fényáram	110 lm/W	
CRI	80 Ra	
Méreték	595 x 595 x 32 mm	295 x 1195 x 32 mm
Védelmi fokozat	IP20	
Üzemi hőmérséklet	-26° ~ 80°C	
Élettartam	akár 20000 óra	
Be-/kikapcsolások száma	15000-ig	

Biztonsági figyelmeztetések

A LED mennyezeti lámpa felszerelése előtt kapcsolja ki a

hálózatot.

Ne csatlakoztassa a LED mennyezeti lámpát az ajánlottól eltérő feszültségre (220-240 VAC).

Az elektromos csatlakoztatást csak engedéllyel rendelkező villanyszerelő végezheti.

Soha ne szerelje szét a LED mennyezeti lámpát. Meghibásodás esetén forduljon egy speciális központhoz.

A LED-ek nem cserélhetők. Cserélje ki a terméket, ha a LED-ek elérték a maximális élettartamot.

A LED mennyezeti lámpát csak beltérben szerelje fel.

Telepítés

A LED mennyezeti lámpa felszerelése előtt kapcsolja ki a fő tápellátást.

Távolítson el egy panelt az álmennyezetről, ahová a LED panelt rögzíti.

Csatlakoztassa a LED panelt a 230 V-os áramforráshoz.

Rögzítse a LED panelt az álmennyezeti szerkezethez.

Kapcsolja be újra a fő tápegységet.

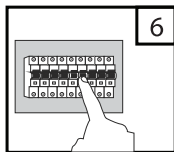
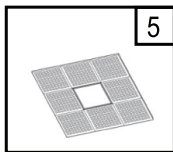
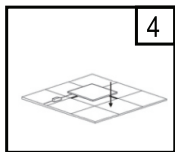
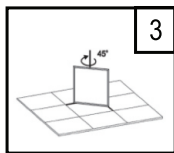
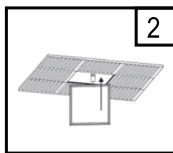
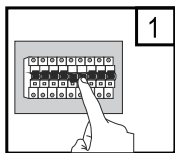

Megfelelőségi nyilatkozat

Az ONLINESHOP SRL kijelenti, hogy a PNI H-Light 6060 / PNI H-Light 1230 LED mennyezeti lámpa megfelel a 2014/30/EU EMC-irányelvnek. Az EU-megfelelőségi nyilatkozat teljes szövege az alábbi internetcímen érhető el:

<https://www.mypni.eu/products/10499/download/certifications>

Specifiche tecniche

	PNI-HL6060	PNI-HL1230
Tensione di ingresso	220 - 240 V AC 50/60 Hz	220 - 240 V AC 50/60 Hz
Potenza	48 W	
Temperatura colore	6400 K	
Angolo fascio luminoso	120°	
Flusso luminoso	110 lm/W	
CRI	80 Ra	
Dimensioni	595 x 595 x 32 mm	295 x 1195 x 32 mm
Grado di protezione	IP20	
Temperatura di funzionamento	-26° ~ 80°C	
Durata	fino a 20000 ore	
Numero di accensione/ spegnimento	fino a 15000	

Avvertenze di sicurezza

Spegnere l'alimentazione di rete prima di installare la plafoniera LED.

Non collegare la plafoniera LED a una tensione diversa da quella consigliata (220-240 VAC).

I collegamenti elettrici devono essere effettuati solo da un elettricista autorizzato.

Non smontare mai la plafoniera LED. In caso di guasto rivolgersi ad un centro specializzato.

I LED non possono essere sostituiti. Sostituire il prodotto quando i LED hanno raggiunto il limite massimo di durata.

Montare la plafoniera LED solo in ambienti interni.

Installazione

Spegnere l'alimentazione principale prima di installare la plafoniera LED.

Rimuovere un pannello dal controsoffitto in cui verrà montato il pannello LED.

Collegare il pannello LED alla fonte di alimentazione a 230 V.

Fissare il pannello LED alla struttura del controsoffitto.

Riaccendere l'alimentazione principale.

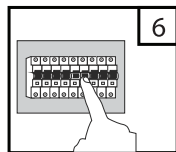
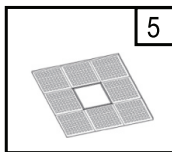
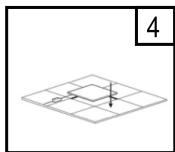
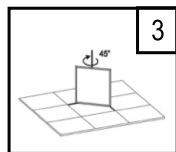
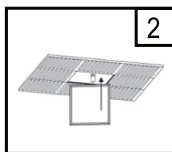
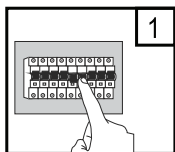

Dichiarazione di conformità

ONLINESHOP SRL dichiara che la Plafoniera LED PNI H-Light 6060 / PNI H-Light 1230 è conforme alla Direttiva EMC 2014/30/UE. Il testo completo della dichiarazione di conformità UE è disponibile al seguente indirizzo internet:

<https://www.mypni.eu/products/10499/download/certifications>

Technische specificaties

	PNI-HL6060	PNI-HL1230
Ingangsspanning	220 - 240 V AC 50/60 Hz	220 - 240 V AC 50/60 Hz
Vermogen	48 W	
Kleurtemperatuur	6400 K	
Stralingshoek	120°	
Lichtstroom	110 lm/W	
CRI	80 Ra	
Afmetingen	595 x 595 x 32 mm	295 x 1195 x 32 mm
Beschermingsgraad	IP20	
Bedrijfstemperatuur	-26° ~ 80°C	
Levensduur	tot 20000 uur	
Aantal aan/uit	tot 15000	

Veiligheidswaarschuwingen

Schakel de netstroom uit voordat u de LED-plafondlamp installeert.

Sluit de LED-plafondlamp niet aan op een andere spanning dan de aanbevolen spanning (220-240 VAC).

Elektrische aansluitingen mogen uitsluitend worden uitgevoerd door een erkende elektricien.

Demonteer de LED-plafondlamp nooit. Neem in geval van een storing contact op met een gespecialiseerd centrum.

LED's kunnen niet worden vervangen. Vervang het product wanneer de LED's de maximale levensduur hebben bereikt.

Monteer de LED-plafondlamp uitsluitend binnenshuis.

Installatie

Schakel de hoofdvoeding uit voordat u de LED-plafondlamp installeert.

Verwijder een paneel van het valse plafond waar u het LED-paneel gaat monteren.

Sluit het LED-paneel aan op de 230V-voeding.

Bevestig het LED-paneel aan de valse plafondstructuur.

Schakel de hoofdvoeding weer in.

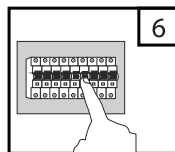
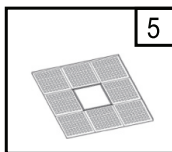
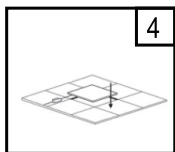
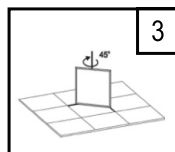
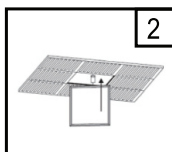
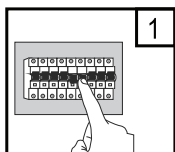

Conformiteitsverklaring

ONLINESHOP SRL verklaart dat de LED-plafondlamp PNI H-Light 6060 / PNI H-Light 1230 voldoet aan de EMC-richtlijn 2014/30/EU. De volledige tekst van de EU-conformiteitsverklaring is beschikbaar op het volgende internetadres:

<https://www.mypni.eu/products/10499/download/certifications>

Specyfikacja techniczna

	PNI-HL6060	PNI-HL1230
Napięcie wejściowe	220 - 240 V AC 50/60 Hz	220 - 240 V AC 50/60 Hz
Moc	48 W	
Temperatura barwowa	6400 K	
Kąt wiązki	120°	
Strumień świetlny	110 lm/W	
CRI	80 Ra	
Wymiary	595 x 595 x 32 mm	295 x 1195 x 32 mm
Stopień ochrony	IP20	
Temperatura robocza	-26° ~ 80°C	
Żywotność	do 20000 godzin	
Liczba włączeń/ wyłączeń	do 15000	

Ostrzeżenia dotyczące bezpieczeństwa

Przed montażem lampy sufitowej LED należy wyłączyć zasilanie sieciowe.

Nie podłączaj lampy sufitowej LED do innego napięcia niż zalecane (220-240 VAC).

Połączenia elektryczne mogą być wykonywane wyłącznie przez uprawnionego elektryka.

Nigdy nie demontuj lampy sufitowej LED. W przypadku awarii należy skontaktować się ze specjalistycznym centrum.

Diody LED nie podlegają wymianie. Wymień produkt, gdy diody LED osiągną maksymalny limit żywotności.

Montuj lampę sufitową LED wyłącznie w pomieszczeniach zamkniętych.

Instalacja

Wyłącz zasilanie główne przed zainstalowaniem oświetlenia sufitowego LED.

Zdejmij panel z sufitu podwieszanego, w którym chcesz zamontować panel LED.

Podłącz panel LED do źródła zasilania 230 V.

Przymocuj panel LED do konstrukcji sufitu podwieszanego.

Ponownie włącz zasilanie główne.

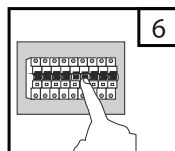
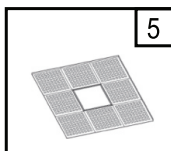
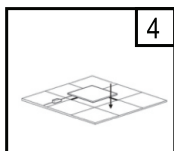
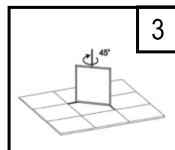
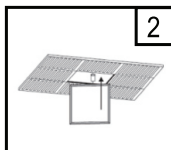
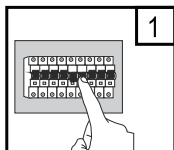

Deklaracja zgodności

ONLINESHOP SRL oświadcza, że lampa sufitowa LED PNI H-Light 6060 / PNI H-Light 1230 jest zgodna z dyrektywą EMC 2014/30/UE. Pełny tekst deklaracji zgodności UE dostępny jest pod następującym adresem internetowym:

<https://www.mypni.eu/products/10499/download/certifications>

Specificatii tehnice

	PNI-HL6060	PNI-HL1230
Tensiune de intrare	220 - 240 V AC 50/60 Hz	220 - 240 V AC 50/60 Hz
Putere	48 W	
Temperatura de culoare	6400 K	
Unghi fascicul luminos	120°	
Flux luminos	110 lm/W	
CRI	80 Ra	
Dimensiuni	595 x 595 x 32 mm	295 x 1195 x 32 mm
Protectie la apa	IP20	
Temperatura de lucru	-26° ~ 80°C	
Durata de viata	pana la 20000 ore	
Numar porniri/ opriri	pana la 15000	

Avertizari de siguranta

Opriti alimentarea la curent inainte de a instala panoul LED.

Nu conectati panoul LED la o sursa de tensiune diferita de cea recomandata (220-240 VAC).

Conexiunile electrice trebuie realizate doar de un electrician autorizat.

Nu desfaceti niciodata panoul LED. In caz de defectiune, apelati la un centru specializat.

LED-urile nu pot fi inlocuite. Inlocuiti produsul cand LED-urile au atins limita maxima de viata.

Montati panoul LED doar la interior.

Instalare

Opriti alimentarea la curent generala inainte de a instala plafoniera LED.

Scoateti un panou din tavanul fals unde urmeaza sa montati panoul LED.

Conectati panoul LED la sursa de curent de 230V.

Fixati panoul LED pe structura tavanului fals.

Reporniti alimentarea generala.

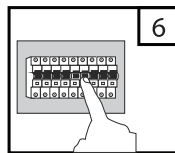
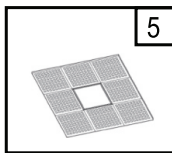
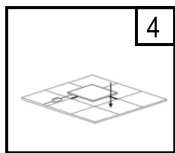
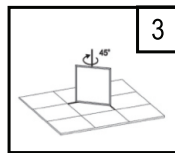
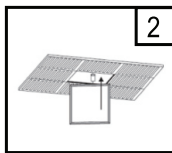
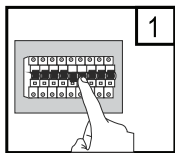

Declaratie de conformitate

ONLINESHOP SRL declara ca **Plafoniera LED PNI H-Light 6060, PNI H-Light 1230** este in conformitate cu Directiva EMC 2014/30/EU. Textul integral al declaratiei UE de conformitate este disponibil la urmatoarea adresa de internet:

<https://www.mypni.eu/products/10499/download/certifications>

CERTIFICATE OF QUALITY AND COMMERCIAL WARRANTY

The products identified in this certificate based on the trade name and the sole series number S/N benefit by a commercial warranty as follows:

The warranty period for natural persons is 24 months as of the delivery date for the manufacturing and material defects.

The warranty period for legal entities is 12 months as of the delivery date for the manufacturing and material defects.

The cables, adaptors, consumables, batteries, accumulators, battery chargers, transformers, microphones, earphones, aerials which are part of the products or are delivered with them shall have a **commercial warranty of 6 months** as of the date of the product sale to the end consumer. The term of warranty shall be calculated as of the invoicing date of each product individually.

The average term of the product service life is 48 months subject to the compliance with the assembly and operation instructions accompanying the product.

The commercial warranty shall not impair the consumer rights provided by the applicable legislation in force, namely Emergency Government Ordinance 140/28.12.2021 on certain issues related to contracts for the sale of goods, the Government Ordinance 21/1992 on the consumer protection as subsequently amended and supplemented by Law 296/2004 on the consumption code as subsequently amended and supplemented.

CERTIFICAT DE CALITATE SI GARANTIE COMERCIALA

Produsele identificate in acest certificat pe baza denumirii comerciale si a numarului unic de serie S/N, beneficiaza de o garantie comerciala dupa cum urmeaza:

Perioada de garantie pentru persoane fizice este de 24 luni de la data livrarii pentru defectele de fabricatie si de material.

Perioada de garantie pentru persoane juridice este de 12 luni de la data livrarii pentru defectele de fabricatie si de material.

Cablurile, adaptoarele, consumabilele, bateriile, acumulatorii, alimentatoarele, transformatoarele, microfoanele, castile, antenele care intra in componenta produselor sau se livreaza impreuna cu acestea au garantie comerciala de **6 luni**

de la data vanzarii produsului catre consumatorul final.

Termenul de garantie se calculeaza de la data facturarii fiecarui produs in parte.

Durata medie de utilizare a produsului este de 48 luni cu conditia respectarii instructiunilor de montaj si utilizare care insotesc produsul.

Garantia comerciala nu afecteaza drepturile consumatorului prevazute prin legislatia aplicabila in vigoare, respectiv Ordonanta de Urgenta 140/28.12.2021 privind anumite aspecte referitoare la contractele de vanzare de bunuri, OG 21/1992 privind protectia consumatorilor cu modificarile si completarile ulterioare si Legea 296/2004 privind codul consumului cu modificarile si completarile ulterioare.

**Please download the full version of the warranty certificate:
Va rugam descarcati versiunea completa a certificatului de garantie:**



