

Priza inteligenta PNI SmartHome SM440

Manual de utilizare



INSTRUCTIUNI DE BAZA

Alimentati priza inteligenta la o sursa de curent de 220V.

Alimentati prin aceasta priza orice aparat electric sau electrocasnic. Puterea maxima suportata este de 3000W (sarcina rezistiva).

Note:

- Priza inteligenta PNI SmartHome SM440 este compatibila doar cu sistemul PNI SmartHome SM400.

- Inainte de a inrola priza inteligenta descarcati aplicatia  "PNI Casa inteligenta" (Android si iOS)

INROLAREA PRIZEI INTELIGENTE IN SISTEM

Pentru a controla de la distanta priza inteligenta, aceasta trebuie inrolata in sistem.

Priza inteligenta PNI SmartHome SM440 poate actiona in doua moduri:

1. **Modul On / Off** - cand primeste un semnal valid, priza inteligenta va intrerupe imediat alimentarea sau va porni alimentarea aparatului electric conectat.

2. Modul actionare temporizata - cand primeste un semnal valid, priza inteligenta va porni alimentarea pentru o anumita perioada de timp (1 minut, 5-15-30-60 minute sau 24h din aplicatia  "PNi Casa inteligenta"), dupa care intrerupe alimentarea. Acest mod de functionare poate avea ca scop si reducerea consumului de energie.

Note:

- Inainte de a inrola priza inteligenta, hotarati modul de operare a acesteia: **On/Off** sau **actionare temporizata**.
- Tasta "Set" de pe priza inteligenta are mai multe functii: ajuta la inrolarea prizei si la setarea cronometrului

Procedura de inrolare a prizei inteligente in modul On/Off:

1. Introduceti un aparat electric in priza inteligenta
2. Alimentati priza inteligenta la o sursa de curent. Ledul rosu clipeste o data.
3. Daca aparatul electric conectat la priza inteligenta are taste de On/Off, puneti-l pe modul On.
4. Apasati o data butonul "Set" de pe priza

inteligenta. Aparatul electric conectat va intra in modul Off

5. Accesati aplicatia  "PNI Casa inteligenta" si urmati pasii de mai jos:

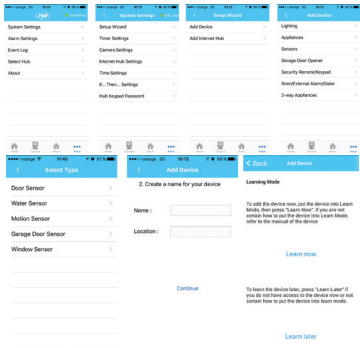

a. Click pe "More" (Mai multe) - "System settings" (Setari sistem) - "Setup Wizard" (Asistent de

- configurare) - "Add device" (Adauga dispozitiv)
- b. Selectati tipul de dispozitiv pe care doriti sa-l adaugati (Lighting sau Appliances).
- c. Dati un nume dispozitivului ales si alegeti o locatie, apoi click pe "Continue" (Continuati).

6. Intorceti-va la priza inteligenta si tineti apasat butonul "Set" pana cand ledul rosu clipeste des.

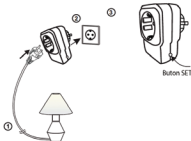

7. In aplicatie apasati "Learn now" (Inroleaza acum).

8. Odata ce priza inteligenta a fost inrolata, ledul rosu clipeste des dupa care se opreste. Priza inteligenta este acum inrolata si poate fi controlata de la distanta.

9. In aplicatie, apasati pe pictograma sub forma de rotita din dreptul dispozitivului adaugat anterior de Dvs. Apasati pe On pentru a porni dispozitivul si pe Off pentru a-l inchide:



Procedura de inrolare a prizei inteligente in modul actionare temporizata:

1. Introduceti un aparat electric in priza inteligenta
2. Alimentati priza inteligenta la o sursa de curent. Ledul rosu clipeste o data.
3. Daca aparatul electric conectat la priza inteligenta are taste de On/Off, puneti-l pe modul On.
4. Apasati o data butonul "Set" de pe priza inteligenta. Aparatul electric conectat va intra in modul Off.

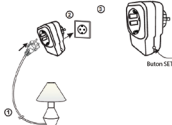

5. Accesati aplicatia "PNI Casa inteligenta" si urmati pasii de mai jos:

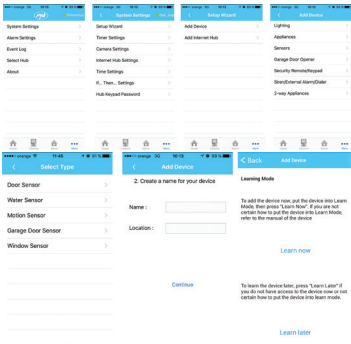

- Click pe "More" (Mai multe) - "System settings" (Setari sistem) - "Setup Wizard" (Asistent de configurare) - "Add device" (Adauga dispozitiv)
- Selectati tipul de dispozitiv pe care doriti sa-l adaugati (Lighting sau Appliances).

c. Dati un nume dispozitivului ales si alegeti o locatie, apoi click pe "Continue" (Continuati).

6. Intorceti-va la priza inteligenta si tineti apasat butonul "Set" pana cand ledul rosu va ramane constant aprins.

7. In aplicatie apasati "Learn now" (Inroleaza acum).

8. Odata ce priza inteligenta a fost inrolata, ledul rosu clipeste des dupa care se opreste. Priza inteligenta este acum inrolata si poate fi controlata de la distanta.

Mod de operare	Indicator led
Mod On/Off	Ledul clipeste
Mod actionare temporizata	Ledul este constant aprins

MODUL ACTIONARE TEMPORIZATA. SETAREA CRONOMETRULUI PRIN BUTONUL "SET"

Daca ati inrolat priza inteligenta pe modul actionare temporizata, urmati pasii de mai jos

pentru setarea cronometrului.

Nota: Cronometrul poate fi setat la 1 minut, 5 minute, 15 minute, 30 minute sau 60 minute, ceea ce inseamna ca dispozitivul alimentat se va stinge dupa 1, 5, 15, 30 sau 60 de minute.

1. Apasati scurt butonul "Set" pentru a pune aparatul electric in modul On.
2. Tineti apasat butonul "Set" timp de 3 secunde. Ledul rosu clipeste o data. Numarul de clipiri indica durata cronometrului:

Numar clipiri	Durata cronometru
1	1 minut
2	5 minute
3	15 minute
4	30 minute
5	60 minute

3. Continuati sa tineti apasat butonul "Set" pana ajungeti la setarea dorita. Starea ledului se va schimba la fiecare 6 secunde. De exemplu,

daca doriti sa treceti de la 1 minut la 5 minute, tineti apasat butonul "Set" timp de 3 secunde. Ledul clipeste o data ceea ce inseamna ca ati setat cronometrul la 1 minut. Continuatii sa tineti apasat butonul "Set" inca 6 secunde. Ledul rosu va clipi de 2 ori, ceea ce inseamna ca ati setat cronometrul la 5 minute.

Nota: Daca ati tinut apasat butonul "Set" pana cand ledul clipeste de 5 ori (adica 60 min) si doriti sa reveniti la setarea cronometrului la 1 minut, eliberati butonul "Set" si reluati procedura de setare a cronometrului plecand de la punctul 1.

4. Apasati scurt butonul "Set" pentru a pune aparatul electric in modul Off.

5. In aplicatie, apasati pe pictograma sub forma de rotita din dreptul dispozitivului adaugat anterior de Dvs. Apasati pe On pentru a porni dispozitivul. Ledul rosu se va aprinde si va ramane aprins pe toata durata numaratorii inverse.



Daca, dupa ce cronometrul a fost setat pe o

anumita valoare (1, 5, 15, 30 sau 60 minute) si aparatul electric a fost pornit (adica numaratoarea inversa a pornit), priza inteligenta primeste o noua comanda de setare a cronometrului, atunci cronometrul o va lua de la capat, ignorand setarea anterioara.

SETAREA CRONOMETRULUI PRIN APLICATIA "PNI CASA INTELIGENTA"

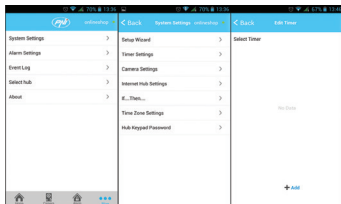

1. Click pe "More" (Mai multe)
2. Click pe "System settings" (Setari sistem)
3. Click pe "Timer Settings" (Setare cronometru)
4. Click pe "+Add" pentru a adauga un nou cronometru

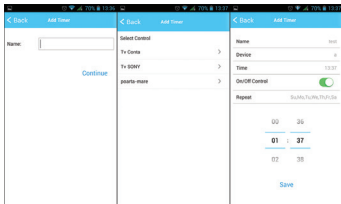

5. Alegeti un nume si dati click pe "Continue" (Continuati)

6. Alegeti dispozitivul de controlat

7. Setati perioada cronometrului. De exemplu: 01:37 inseamna ca peste o ora si 37 de minute aparatul electric conectat la priza electrica se va inchide.

8. Intorceti-va la interfata principala a aplicatiei si faceti click pe rotita din dreptul dispozitivul Dvs. In interfata care se deschide apasati pe "On". Din acest moment incepe numaratoarea inversa.

Nota: Pentru a pastra priza inteligenta inrolata in sistem, aceasta trebuie sa fie alimentata tot timpul la o sursa de curent.

STERGEREA PRIZEI INTELIGENTE DIN SISTEM

Daca aveti mai multe prize inteligente inrolate in sistem, nu puteti sterge doar o singura priza, ci trebuie sa le stergeti pe toate, ca mai apoi sa le inrolati din nou pe cele pe care doriti sa le pastrati.

1. Intrerupeti alimentarea prizei electrice, indepartand-o de la sursa de curent
2. Tineti apasat butonul "Set" in timp ce alimentati din nou priza inteligenta la sursa de curent
3. Ledul rosu se va aprinde, apoi timp de o secunda va clipi repede, dupa care se va aprinde si se va stinge iar.
4. Eliberati butonul "Set". Acum ati sters toate prizele inteligente inrolate in sistem.

SPECIFICATII TEHNICE:

Alimentare: 220V, 50Hz

Consum in standby: 3mA

Sarcina rezistiva: maxim 3000W

Sarcina inductiva: maxim 230W

Sarcina minima: 7W

Frecventa: 433.9 MHz

Dimensiune: 87x58x79mm

Raza de actiune: pana la 100 m in camp deschis

Temperatura de lucru: -20°C ~ + 60°C

Smart plug-in On/Off socket **PNI SmartHome SM440**

User manual



BASIC INSTRUCTIONS

Plug the on/off socket to a 220V electrical outlet, then plug in a light or home appliance. The maximum power is about 3000W.

Notes:

- PNI SmartHome SM440 plug-in on/off socket is compatible only with the alarm system PNI SmartHome SM400.
- Before programming the plug-in on/off socket, please download  "PNI Casa inteligente" app (Android and iOS)

PROGRAMMING THE ON/OFF SOCKET

In order to remotely control the on/off socket, it must be first programmed.

PNI SmartHome SM440 has two operating modes:

1. **On / Off** mode- when it receives a valid signal, the socket will immediately turn on/off the electrical device connected to it.
2. **Countdown timer mode** - when it receives a valid signal, the socket will turn the power on for a preset period of time (1 minute, 5-15-30 or 60 minutes), then it cuts the power off.

Notes:

- Before you program the socket, decide the operating mode: **On/Off** or **Countdown timer**.
- "Set" button on the socket has multiple functions: it helps programming the socket and setting the timer.

Programming the socket in On/Off mode:

1. Plug in an electrical device in the smart socket
2. Plug the smart socket to an 220V outlet. The red led flashes one time.
3. If the electric device connected to the smart socket has on/off button, then turn it on.
4. Push once the "Set" button on the smart socket. The electric device connected to the smart socket will turn off.

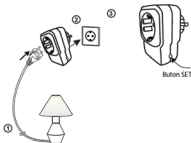

5. Open  "PNI Casa inteligente" app and follow the instructions below:

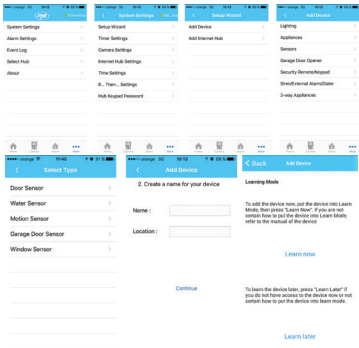

- Click "More" - "System settings" - "Setup Wizard" - "Add device"
- Select the device you want to add (Lighting or Appliances).
- Choose a name and a location, then click "Continue".

6. Return to the smart socket and push "Set" button until the red led flashes.
7. In the app push "Learn now".
8. Once the smart plug is programmed, the red led flashes, then it turns off. The smart socket is now programmed and it can be controlled remotely.
9. In the app, push on and off to turn on and off the connected electrical device:



Programming the smart socket in countdown timer mode:

1. Plug in an electrical device in the smart socket
2. Plug the smart socket to an 220V outlet. The red led flashes one time.
3. If the electrical device connected to the smart socket has on/off button, then turn it on.
4. Push once the "Set" button on the smart socket. The electrician device connected to the smart socket will turn off.

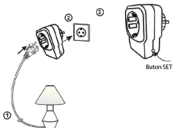

5. Open  "PNI Casa inteligente" app and follow the instructions below:

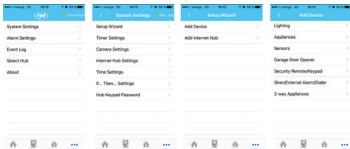

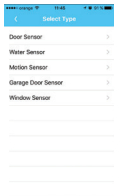

- a. Click "More" - "System settings" - "Setup Wizard" - "Add device"
 - b. Select the device you want to add (Lighting or Appliances).
 - c. Choose a name and a location, then click "Continue".
-
6. Return to the smart socket and push "Set" button until the red led stops and it is steadily on.
 7. In the app push "Learn now".
 8. Once the smart plug is programmed, the red led flashes, then it turns off. The smart socket is now programmed and it can be controlled remotely.

operating mode	Led indication during programming
On/Off mode	The led flashes
Countdown timer mode	The led is steadily on

COUNTDOWN TIMER MODE. SETTING THE TIMER WITH "SET" BUTTON

If you have programmed the smart socket on timer mode, follow the steps below in order to set the timer.

Note: The timer can be set to 1 minute, 5 minutes, 15 minutes, 30 minutes or 60 minutes, which means that the electrical device will be on for 1, 5, 15, 30 or 60 minutes.

1. Press one "Set" button to turn on the electrical device.
2. Push again "Set" button and hold for about 3 seconds. The red led flashes once. The number of flashed indicates the timer duration:

Number of flashes	Timer duration
1	1 minute
2	5 minutes
3	15 minutes
4	30 minutes
5	60 minutes

3. Continue to hold "Set" button till you get to the desired setting. The led status changes every 6 seconds. For example, if you want to go from 1 minute to 5 minutes, hold "Set" set button for 3 seconds. The led flashes once, which means that the timer is set to 1 minute. Continue to hold "Set" button for another 6 seconds. The red led flashes 2 times, which means that the times is set to 5 minutes.

Note: If you have set the timer to 60 minutes and you have changed your mind and want to set it again to 1 minute, then repeat all the above steps.

4. Press once "Set" button in order to turn off the electrical device.

5. In the app push On button, in order to turn on the electrical device. The red led turns on and it will stay on for the whole time of the countdown.

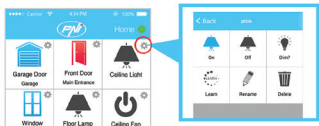

SETTING THE TIMER WITH "PNI CASA INTELIGENTA" APP

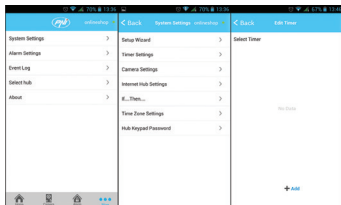

1. Click "More"

2. Click "System settings"
3. Click "Timer Settings"
4. Click "+Add" to add a new timer

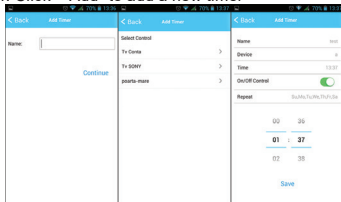

5. Choose a name and click "Continue"
 6. Choose the electrical device you want to set
 7. Set the timer. For example: 01:37 means that in 1 hour and 37 minutes the electrical device will turn off.
 8. Go back to the main interface of the app and click the gear next your device icon. From this instance, the countdown is on.
- Note: To keep the smart socket programmed you must let it always plugged to an electrical outlet.

ERASING THE SMART SOCKET FROM THE SYSTEM

If you have more than one smart socket programmed in the same system, you cannot erase just one. You must delete all of them and then program again only those you want to keep..

1. Unplug the smart socket
2. Hold "Set" button while you plug again the smart socket
3. The red led will turn on, then for about one second will flash quickly, then it will turn again on and off..
4. Release "Set" button. Now, all the smart sockets have been erased from the system.

TECHNICAL SPECIFICATIONS:

Power voltage: 220V, 50Hz

Standby power consumption: 3mA

Resistive load: max. 3000W

Inductive load: max. 230W

Minimum load: 7W

Frequency: 433.9 MHz

Dimension: 87x58x79mm

Range: up to 100 m

Working temperature: -20°C ~ + 60°C