



PNI SafeHome Cleaner PTA200

Smart air purifier / Purificator de aer inteligent



EN	User manual	3
RO	Manual de utilizare	12

Tuya Smart APP

Download the **Tuya Smart** app by accessing Google Play or the App Store or scan the QR codes below:



Android

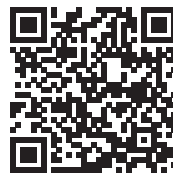

iOS

Add device in Tuya Smart application

1. Open the application, create an account and log in.
2. Add your device by pressing the **+** icon in the upper right corner of the screen or by clicking the **Add device** button (this button appears when you have no device added to the application).
3. Select the option **Small Home Appliances** on the left side of the screen.
4. From the list of devices on the right side of the screen, select **Air Purifier** .
5. Select the WiFi network you want to connect to and add the password.
6. Power your device (air purifier) to a power source. While the device is off and the screen is off (only the center On / Off button is lit red), press and hold the WiFi button in the lower left corner of the control panel until the WiFi icon flashes on the panel.
7. Check the option **Confirm indicator rapidly blinks** in the application.
8. The application will scan the devices within its range.
9. After you identify your device, you will receive the confirmation **Added**

successfully.

10. To finish, click the **Done** button.

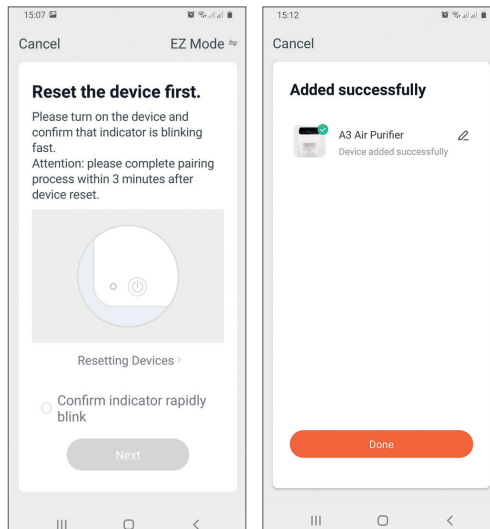
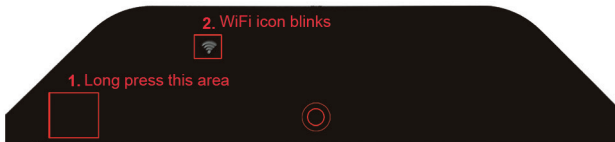
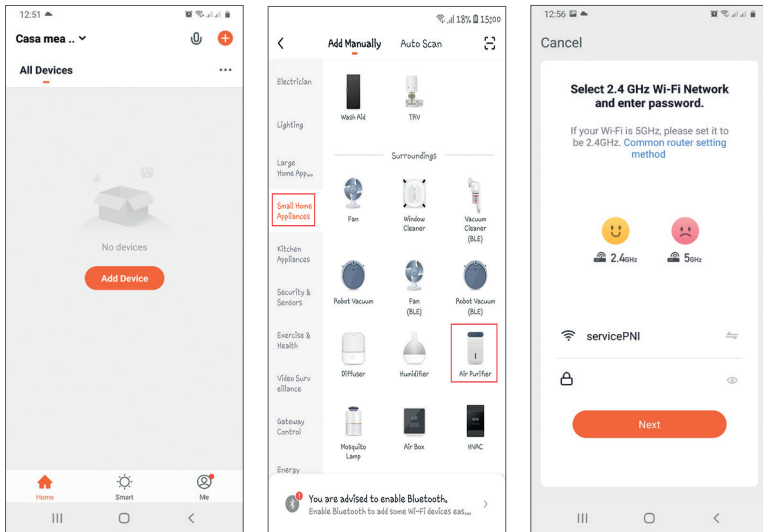

Device control in the application

1. Select your air purifier from the list of added devices and choose the desired command:
 - Turn the purifier on and off
 - Change the operating mode: Manual, Automatic or Sleep
 - Set fan speed (3 levels)
 - Make general settings such as activating anion release, activating child protection mode and setting the operating program (Timer).

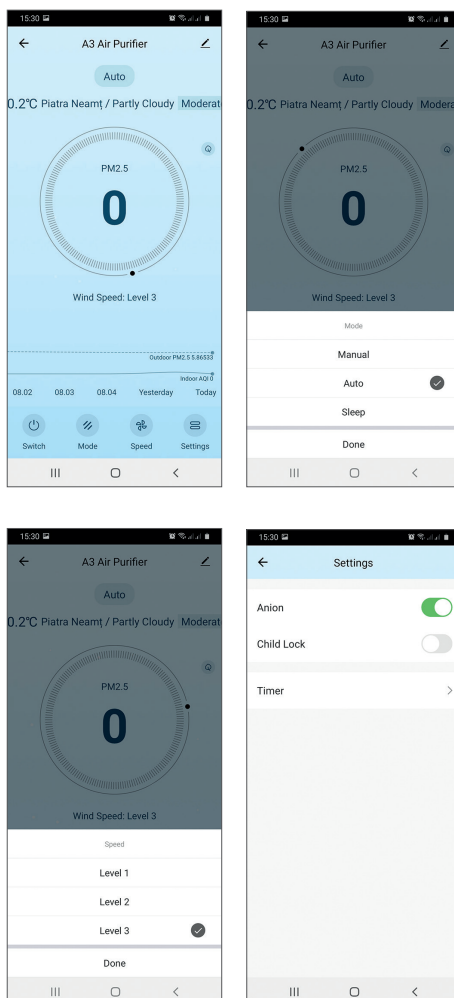

Safety warnings

- Do not install the purifier in direct sunlight, near heat sources or interference sources (TV, radio).
- We recommend positioning the purifier on the floor, as certain pollutants (dust, pollen) are deposited in this area.
- Leave a distance of at least 30 cm between the purifier and other objects.
- Do not cover the inlet or outlet area of the purifier with objects.
- Do not move the purifier while it is running. Shocks could damage the engine.
- Do not use a power supply other than the recommended one (230VAC 5A).
- Do not insert objects into the grille where air enters.
- This purifier does not replace hoods, vacuum cleaners and other ventilation equipment used in the house.
- Do not use the purifier in the area with excessive humidity (bathroom, kitchen).
- Position the purifier on a flat and stable surface.
- Do not use the purifier in an area where you have used gaseous anti-insect solutions. If you have used such products, ventilate the room well before starting the purifier.
- In case of failure, do not repair the product yourself, call a specialized service center.

Technical specifications

Supply voltage	230V
Power	43W
Airflow (CADR)	200m ³ /h
CCM	P1
Noise level	57 dB(A)
Recommended space	14 - 24 m ²
Dimensions	325 x 172 x 510 mm

Product description

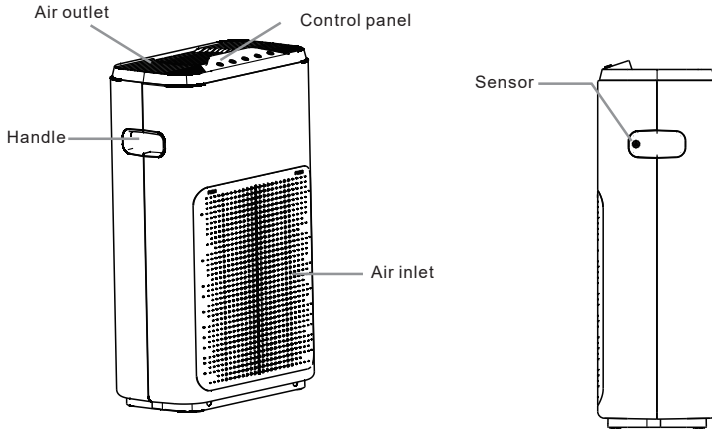

Control panel

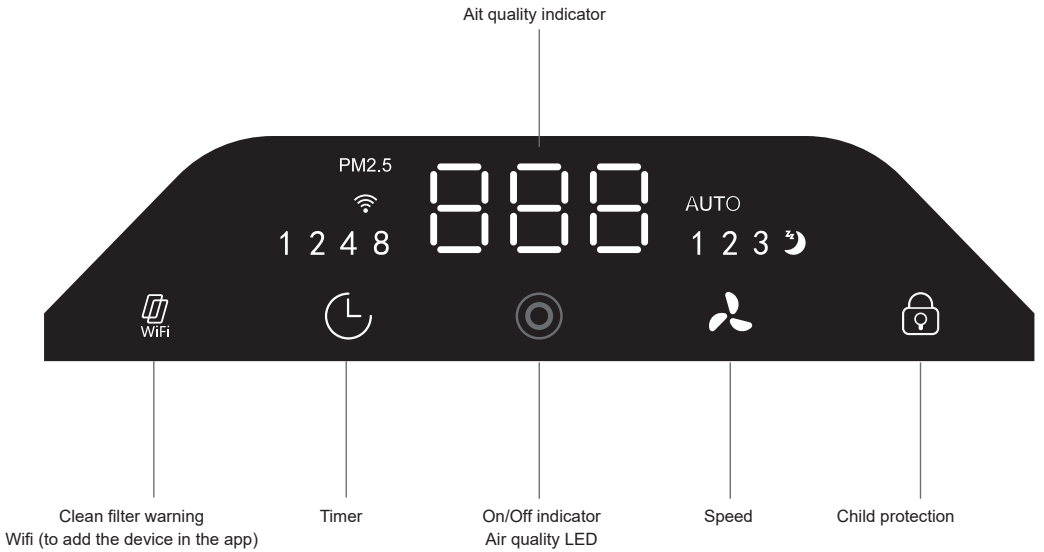

Filters

Pre-filter

The pre-filter is the first filter that purifies the air. It filters dust particles, pollen and other pollutants with a diameter > 5 microns. This filter can be cleaned and reused.

HEPA + active carbon filter

The activated carbon filter filters out harmful gases such as benzene, toluene, xylene, formaldehyde and ammonia.

The HEPA filter filters particles with a diameter > 0.3 microns such as bacteria, smoke or dust. The filtration efficiency is $> 99\%$. The HEPA filter combined with another type of filter can filter particles with a diameter of > 20 nanometers.

Filter installation instructions

- Remove the cover from the front of the purifier (air inlet area).
- Remove the filter from the purifier, remove the plastic bag in which it is packed and reposition the filter in the purifier.
- Replace the cover.

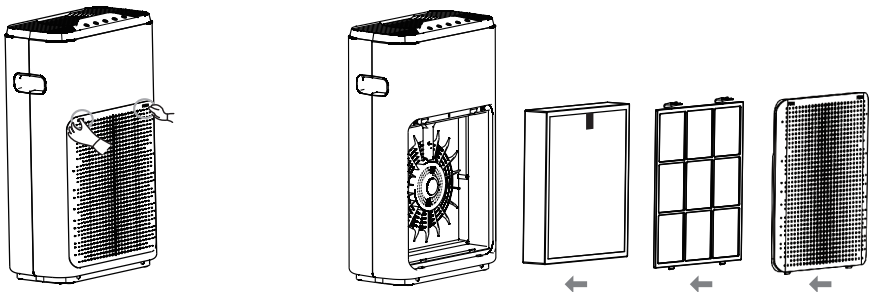

Filter maintenance

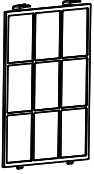

Clean the pre-filter approximately every 6 months of use. Use a vacuum cleaner to first clean the surface of the filter, then wash it with water. Make sure it is well dried before reinstalling it in the purifier.

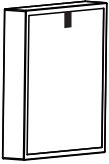

Clean the HEPA + active carbon filter every 2 months of use. When the filter indicator on the control panel flashes (1500 hours of use have elapsed), first press the Reset key to exit the warning mode and reset the timer, then remove and clean the filter.



Warnings:



- Do not wash the HEPA filter with water.
- When cleaning the HEPA filter, stay in an open area so that you do not inhale unhealthy particles that are trapped in the filter.
- Do not expose the filter to direct sunlight for a long time.

Other warnings:

- Disconnect the purifier from the power supply before maintenance.
- Do not use the purifier without filters.
- If you do not use the purifier for a long time, disconnect it from the mains.
- If you use the purifier in a heavily polluted space (for example, where there is a lot of smoking), the filters must be cleaned or replaced more often.





Usage instructions

1. **Power supply:** After connecting the purifier to the mains, you will hear a “Di” sound. The purifier will enter standby mode and the status LED () will become red.
2. **Start:** Press the key  to start the air purifier. The air quality indicator () will become red. The purifier will enter the automatic operation mode.

- 3. Timer:** Press the key  to program the operating time: 1 hour, 2 hours, 4 hours or 8 hours.
- 4. Speed:** Press the key  to adjust the air circulation speed (engine speed). 3 levels are available, plus Sleep mode and AUTO mode.

Air quality indicators (in AUTO mode)

Air quality indicator	Led color	Air quality level	Recommended speed
1 - 100	Green	Excellent	1
101 - 200	Yellow	Good	2
201 - 500	Red	Weak	3

- 5. Child protection:** Press the key  to lock the keys on the control panel so that children do not have access to it. Press and hold this key for 3 seconds to exit protection mode.
- 6. Reset:** Long press the key  to reset the purifier. After reset, the timer (for filter change) will be reset and the purifier will be disconnected from WiFi (if it was connected to WiFi and was added in the Tuya Smart application). The reset takes a few minutes, during which time the icon  will blink.
- 7. Stop:** Press the key  to turn off the purifier. It will enter standby mode. The status light stays on.

Troubleshooting

- The air purifier does not start.
 - Make sure you plug in the power cord.
 - Make sure that the air outlet is not blocked.
- No key on the control panel responds to touch.
 - Make sure the filters are clean or have been replaced.
- A smell comes out of the air purifier.
 - Make sure you remove the filter from the plastic bag.

- Make sure you have installed the filters correctly.
 - Make sure the filters are clean.
4. The purifier has been running for several hours, but the air quality does not seem to have improved.
- Check that the filter change warning light is on. Clean the filters if necessary and reset the purifier before reinstalling them.

Aplicatia Tuya Smart

Descarcati aplicatia **Tuya Smart** accesand Google Play sau App Store sau scanati codurile QR de mai jos:



Android



iOS

Adaugare dispozitiv in aplicatia Tuya Smart

1. Deschideti aplicatia, creati-va cont si autentificati-va.
2. Adaugati dispozitivul dvs. apasand pictograma **+** din coltul dreapta sus al ecranului sau apasand butonul **Add device** (acest buton apare atunci cand nu aveti nici un dispozitiv adaugat in aplicatie).
3. Selectati din partea stanga a ecranului optiunea **Small Home Appliances**.
4. Din lista de dispozitive din partea dreapta a ecranului, selectati **Air Purifier** .
5. Selectati reseaua WiFi la care doriti sa va conectati si adaugati parola.
6. Alimentati la o sursa de curent dispozitivul dvs. (purificatorul de aer). Cat timp dispozitivul este oprit si ecranul stins (doar butonul central On/Off este aprins de culoare rosie) apasati lung pe zona unde se afla butonul WiFi, in coltul stanga jos a panoului de control, pana cand pictograma WiFi clipeste pe panou.
7. Bifati in aplicatie optiunea **Confirm indicator rapidly blinks**.
8. Aplicatia va scana dispozitivele din raza sa.

9. După ce va identifica dispozitivul dvs., veți primi confirmarea **Added successfully**.

10. Pentru a finaliza, faceți click pe butonul **Done**.

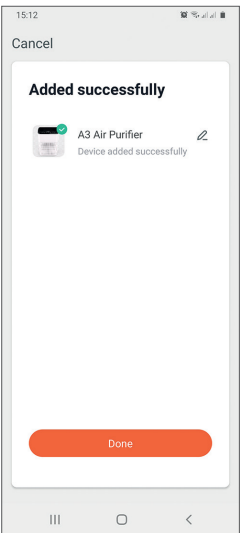
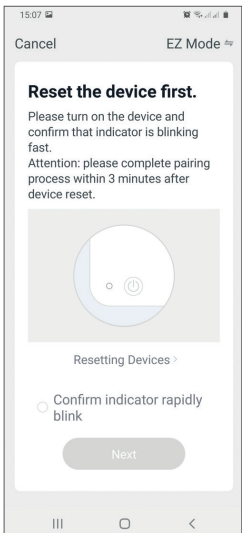
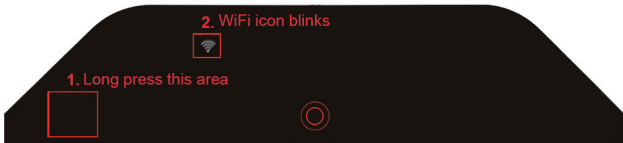
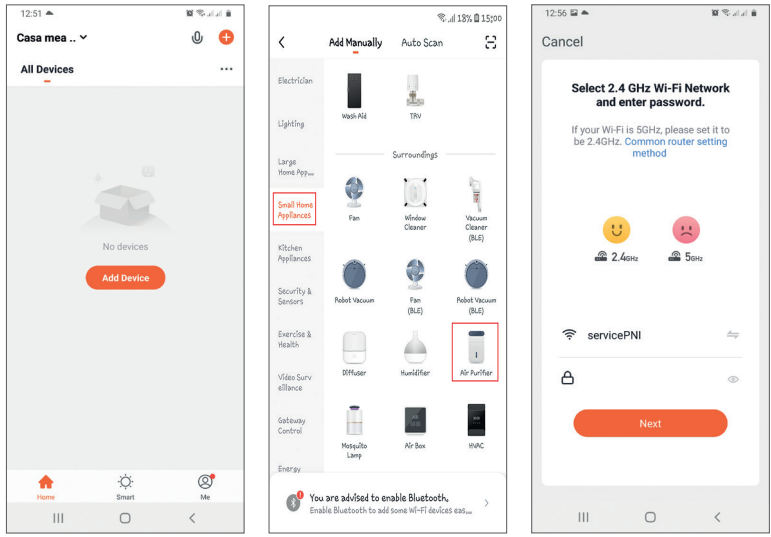

Control dispozitiv din aplicatie

1. Selectati din lista de dispozitive adaugate purificatorul dvs. de aer si alegeti comanda dorita:
 - Porniti si opriti purificatorul
 - Schimbati modul de functionare: Manual, Automat sau Sleep
 - Setati viteza ventilatoarelor (3 niveluri)
 - Efectuati setari generale precum activarea eliberarii de anioni, activare mod protectie copil si setare program de functionare (Timer).

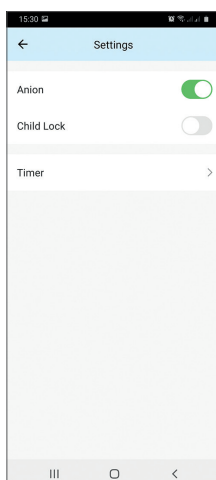
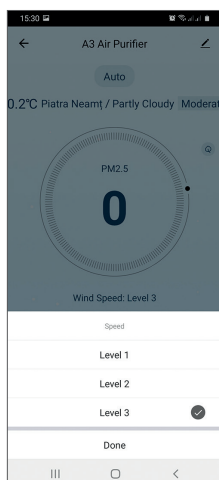
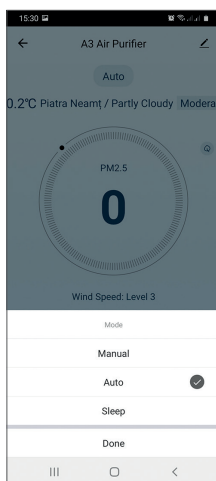
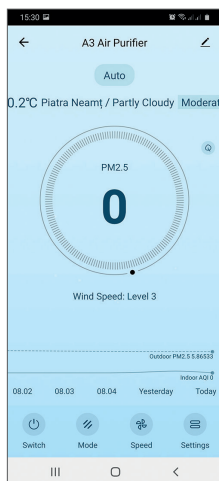

Atentionari de siguranta

- Nu instalati purificatorul in bataia directa a soarelui, in apropierea surselor de caldura, a surselor de interferenta (TV, radio).
- Recomandam pozitionarea purificatorului pe podea, intrucat anumiti poluanti (praf, polen) se depun in aceasta zona.
- Lasati o distanta de cel putin 30 de cm intre purificator si alte obiecte.
- Nu acoperiti cu obiecte nici zona de intrare, nici cea de iesire a aerului de pe purificator.
- Nu miscati purificatorul in timp ce functioneaza. Socurile ar putea defecta motorul.
- Nu folositi alta sursa de alimentare decat cea recomandata (230VAC 5A).
- Nu introduceti obiecte in grilajul pe unde intra aerul.
- Acest purificator nu inlocuieste hotele, aspiratoarele si alte echipamente de ventilatie folosite in casa.
- Nu folositi purificatorul in zona cu umiditate excesiva (baie, bucatarie).
- Pozitionati purificatorul pe o suprafata plata si stabila.
- Nu folositi purificatorul intr-o zona in care ati dat cu solutii gazoase anti-insecte. Daca ati folosit astfel de produse, aerisiti bine incaperea inainte de a porni purificatorul.
- In caz de defectiune, nu reparati produsul singur, apelati la un centru service specializat.

Specificatii tehnice

Tensiune de alimentare	230V
Putere	43W
Flux de aer (CADR)	200m ³ /h
CCM	P1
Nivel de zgomot	57 dB(A)
Suprafata recomandata	14 - 24 m ²
Dimensiuni	325 x 172 x 510 mm

Descriere produs

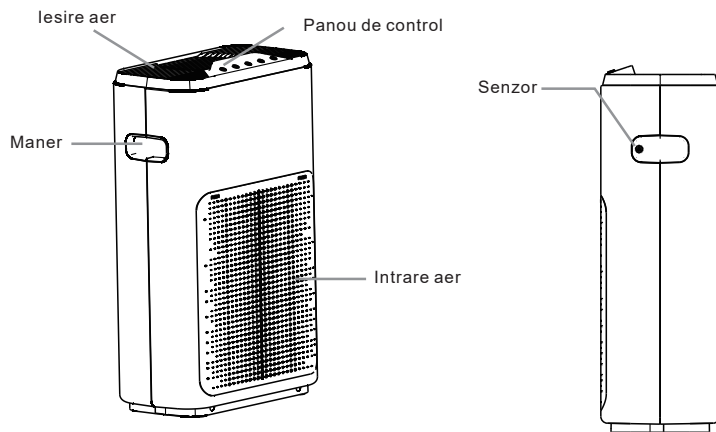

Panoul de control



Filtre

Pre-filtru

Pre-filtrul este filtrul primul filtru care purifica aerul. El filtreaza particule de praf, polen si alti poluanti cu diametru >5 microni. Acest filtru poate fi curatat si reutilizat.

Filtru HEPA+carbon activ

Filtrul din carbon activ filtreaza gaze daunatoare sanatatii precum benzen, toluen, xilen, formaldehida si amoniac.

Filtrul HEPA filtreaza particule cu diametru >0.3 microni precum bacterii, fum sau praf. Eficienta de filtrare este de $>99\%$. Filtrul HEPA combinat cu alt tip de filtru poate filtra particule cu un diametru de >20 nanometri.

Instructiuni de instalare filtru

1. Instalati filtrul
 - Indepartati capacul de pe partea frontala a purificatorului (zona intrare aer)
 - Scoateti filtrul din purificator, indepartati punga de plastic in care este ambalat si repositionati filtrul in purificator
 - Puneti capacul la loc.

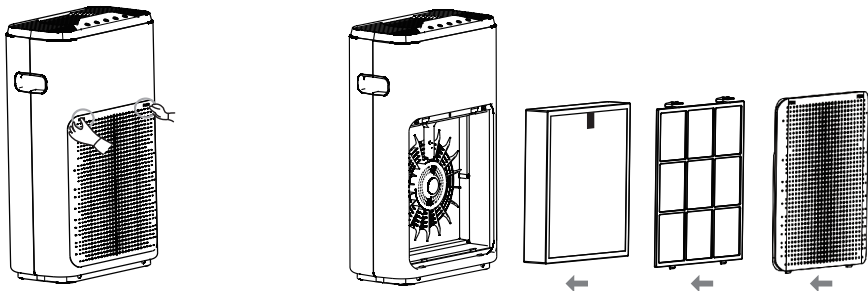

Intretinerea filtrelor

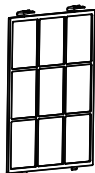

Curatati pre-filtrul aproximativ la fiecare 6 luni de utilizare. Utilizati un aspirator pentru a curata mai intai suprafata filtrului, dupa care spalati-l cu apa. Asigurati-va ca este bine uscat inainte de a-l reinstala in purificator.

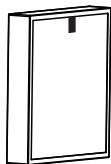

Curatati filtrul HEPA + carbon activ la fiecare 2 luni de utilizare. Cand indicatorul pentru filtru de pe panoul de control clipeste (adica au fost depasite 1500 de ore de utilizare), apasati mai intai tasta Reset pentru a iesi din modul de avertizare si pentru a reinitializa temporizatorul, dupa care scoateti si curatati filtrul.



Avertizari:

- Nu spalati filtrul HEPA cu apa.
- Cand curatati filtrul HEPA, stati intr-o zona deschisa, astfel incat sa nu inhalati particulele nesanatoase care sunt blocate in filtru.
- Nu expuneti filtrul la razele directe ale soarelui timp indelungat.



Alte avertizari:

- Deconectati de la curent purificatorul inainte de operatiunile de intretinere.
- Nu folositi purificatorul fara filtre.
- Daca nu folositi purificatorul timp indelungat, deconectati-l de la curent.
- Daca folositi purificatorul intr-un spatiu foarte poluat (de exemplu, unde se fumeaza mult), curatarea filtrelor sau inlocuirea acestora trebuie sa se efectueze mult mai des.

Instructiuni de utilizare





1. **Alimentare:** Dupa ce ati conectat purificatorul la curent, veti auzi un sunet "Di". Purificatorul va intra in modul standby, iar ledul de stare () va deveni rosu.
2. **Pornire:** Apasati tasta  pentru a porni purificatorul. Indicatorul calitatii aerului () va fi la inceput rosu. Purificatorul va intra in

modul automat de functionare.

3. **Temporizator:** Apasati tasta  pentru a programa timpul de functionare: 1 ora, 2 ore, 4 ore sau 8 ore.
4. **Viteza:** Apasati tasta  pentru a regla viteza de circulatie a aerului (viteza motorului). Sunt disponibile 3 niveluri, plus modul Sleep si modul AUTO.

Indicatori calitate aer (in modul AUTO)

Indicator calitate aer	Culoare led	Nivel calitate aer	Nivel viteza recomandata
1 - 100	Verde	Excelent	1
101 - 200	Galben	Bun	2
201 - 500	Rosu	Slab	3

5. **Protectie copii:** Apasati tasta  pentru a bloca tastele, astfel incat copiii sa nu aiba acces la panoul de control. Apasati lung timp de 3 secunde aceasta tasta pentru a iesi din modul de protectie.
6. **Reset:** Apasati lung tasta  pentru a reseta purificatorul. Dupa reset, timer-ul (pentru schimbare filtru) se va reinitializa, iar purificatorul se va deconecta de la WiFi (daca acesta a fost conectat la WiFi si a fost adaugat in aplicatia Tuya Smart). Resetarea dureaza cateva minute, timp in care pictograma  va clipi.
7. **Oprire:** Apasati tasta  pentru a opri purificatorul. Acesta va intra in modul standby. Ledul de stare ramane aprins.

Probleme si solutii

1. Purificatorul nu porneste.
 - Asigurati-va ca ati bagat cablul de alimentare in priza.
 - Asigurati-va ca iesirea pentru aer nu este blocata.
2. Nici o tasta de pe panoul de comanda nu raspunde la atingere.
 - Asigurati-va ca filtrele sunt curate sau ca le-ati inlocuit.

3. Iese un miros din purificator.
 - Asigurati-va ca ati scos filtrul din pungă de plastic.
 - Asigurati-va ca ati instalat corect filtrele.
 - Asigurati-va ca filtrele sunt curate.
4. Purificatorul functioneaza de cateva ore, dar calitatea aerului nu pare sa se fi imbunatatit.
 - Verificati daca ledul de avertizare schimbare filtru este aprins. Curatati filtrele daca este necesar si resetati purificatorul inainte de reinstalarea acestora.

EN:**EU Simplified Declaration of Conformity**

SC ONLINESHOP SRL declares that **Smart air purifier PNI SafeHome PTA200** complies with the Directive EMC 2014/30/EU and RED 2014/53/UE. The full text of the EU declaration of conformity is available at the following Internet address:

<https://www.mypni.eu/products/7295/download/certifications>

RO:**Declaratie UE de conformitate simplificata**

SC ONLINESHOP SRL declara ca **Purificator de aer inteligent PNI SafeHome PTA200** este in conformitate cu Directiva EMC 2014/30/EU si RED 2014/53/UE. Textul integral al declaratiei UE de conformitate este disponibil la urmatoarea adresa de internet:

<https://www.mypni.eu/products/7295/download/certifications>

