

4W MOBILE CB TRANSCEIVER TCB-900evo

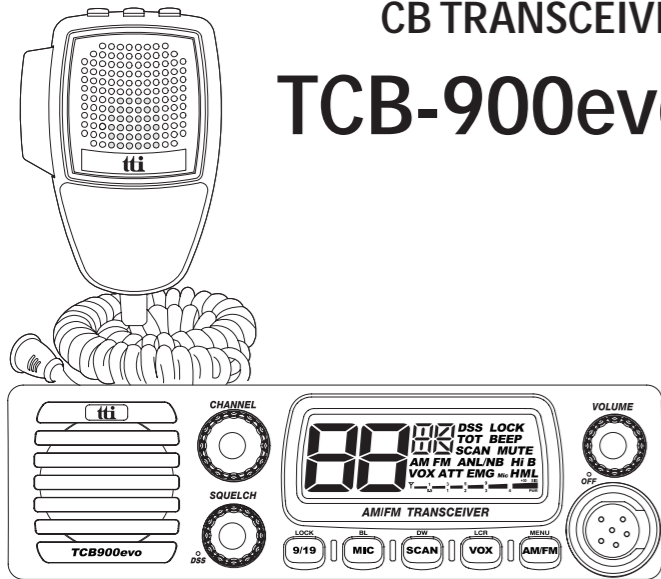

INSTRUCTION MANUAL



www.ttikorea.co.kr

P/N 820-C900-E00

1. Supplied Accessories

Your transceiver is supplied with a full range of accessories to help you get started and virtually benefit from all the features straight away.

TCB-900evo Transceiver	1 unit
Microphone with cord	1 unit
Power cable	1 unit
Radio mounting bracket	1 unit
Radio mounting thumb screw with rubber washer	2 pieces
Mounting screw with washer (for transceiver bracket)	3 pieces
Mounting screw with washer (for microphone bracket)	2 pieces
Microphone mounting bracket	1 unit

2. Installation

Normal Installation using Mounting Bracket

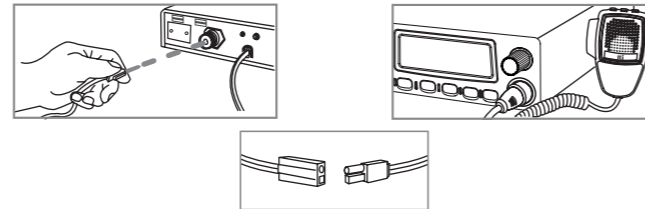

- Put the mounting bracket on the proper location where you are going to install.
- Drill holes and fix mounting bracket on the location.
- Connect the antenna cable plug to the standard receptacle on the transceiver, which is marked "ANT".
- Connect the power cable directly to the vehicle battery or fuse box of the car. Be careful to make sure of the polarity of the battery first and connect the cable. (Red: Positive Pole(+), Black: Negative Pole(-). The same colors are shown on the battery and in the fuse box of the car.)
- Connect the power cable to the transceiver cable.
- Mount the microphone bracket on one side of the transceiver, or near it using two screws included.
- Connect the microphone to the transceiver's microphone receptacle. Now you are ready to operate the transceiver.

Installing into Audio Compartment

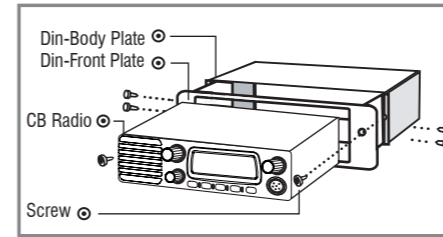

- Install the Din-Body plate into the audio compartment (center fascia) of your vehicle. (Use the ready made locking flaps.)
- Set the transceiver in the Din-Front plate, and insert the transceiver in the Din-Body plate.
- Fix the screws through the transceiver, Din-Front plate and Din-Body plate.

Installing an Antenna

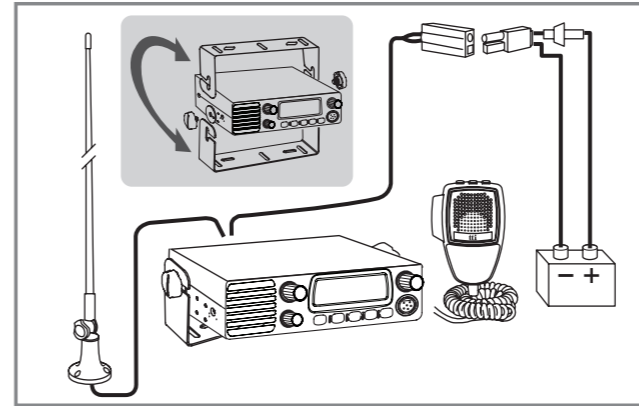

- Place the antenna as high as possible.
- The longer the antenna is, normally the better is the performance of the transceiver.
- Try to mount the antenna in the centre of the surface that you select.
- Make sure that you have a solid metal-to-metal ground connection.
- Be careful not to damage the cable during the installation.

Warning : Never try the operation of your transceiver before connecting a proper antenna in order not to cause any damage.

3. LCD Display

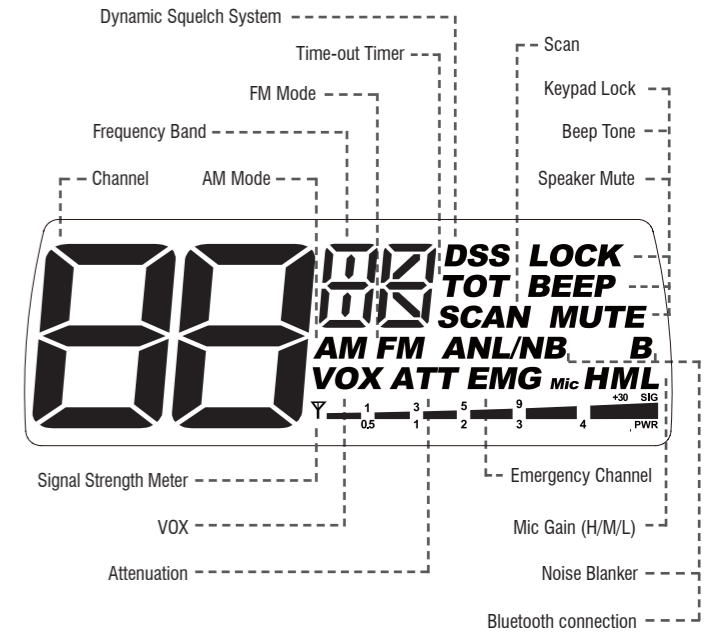

4. Transceiver Controls and Functions

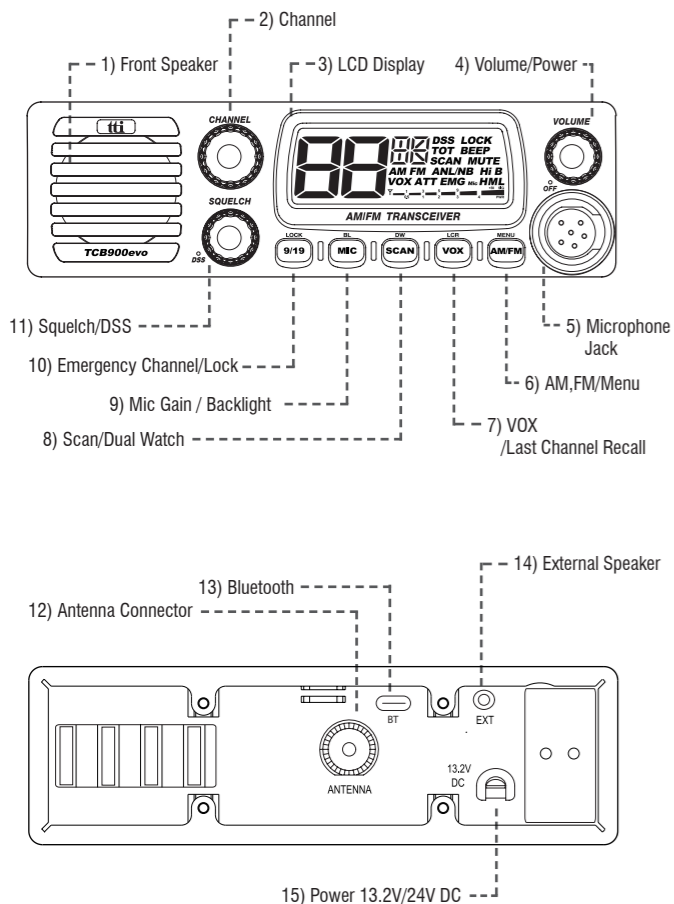

- Front Speaker
- Channel Selector
Turn right or left, and this allows you to select the channel one by one.
- LCD Display
- Volume / Power Knob
- Microphone Jack
- AM,FM / Menu Button
Short press to change AM / FM.
Long press to access Menu mode. Use the Channel knob to select the setting.
On the Microphone, press center key (VOX button) to access Menu mode. Use Up/Down key to select the setting.

<MENU>

Display	Functions	Settings
bn	Band Selection	See next band chart
bt	Bluetooth Selection	On, Off
nb	Noise Blanker	On, Off
bP	Beep Tone	On, Off
to	Time-out Timer	1-99 sec., Off
At	Attenuation	On, Off

<BAND Chart>

Setting	Display	Settings
EC	EC	Europe 40ch. FM 4W
EU	EU	Europe 40ch. AM/FM 4W
D	d	Germany 80ch. FM 4W, 40ch. AM 4W
I2	i2	Italy 34ch. AM/FM 4W
I	i	Italy 40ch. AM/FM 4W
UE(EU/UK)	UE	UK 40ch. FM 4W (British Frequencies) + CEPT 40ch. FM 4W(EC)
UK	UH	UK 40ch. FM 4W (British Frequencies)
PL	PL	Poland 40ch. AM/FM 4W (Polish Frequencies : 5KHz)
F	F	France 40ch. FM 4W, 40ch AM 4W
E	E	Spain 40ch. AM/FM 4W

- VOX / LCR Button
Short press to activate the VOX. Using the Mic gain the sensitivity can be adjusted.
Long press to go to the Last Channel you have used.
- Scan / Dual Watch Button
Short press to activate Scan function.
Long press to activate Dual Watch function. The current channel is the home channel and the secondary channel can be selected by the channel selection knob.
- Mic Gain / Backlight
Short press to change the Mic Gain level to high (H), mid (M) and low (L) with the display indication.
Long press to change backlight color.

- 9/19 / Lock Button
Short press to go to the emergency channel (9 or 19).
Long press to lock keypad. The volume, squelch and 9/19 buttons are still working.

- Squelch / DSS Knob
Manual Adjustment : Turn this knob counter-clockwise until you hear the background noise and then turn the knob a little clockwise until the noise disappears. In this way, you get the best receive sensitivity.
DSS : In FM mode turn the knob counter-clockwise until you hear the click. The squelch level of your transceiver is dynamically adjusted.

- Antenna Connector
- Bluetooth Dongle Connection
- External Speaker Jack
- Power 13.2V / 24V DC

5. Microphone

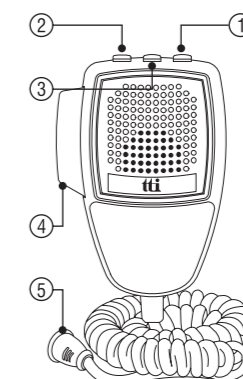

- Up Button
- Down Button
- Mute / VOX Button
Mute : Momentary press the button to make mute the speaker.
VOX : Press long then VOX will be activated.
- PTT Button
- 6 Pin Microphone Connector

6. How to operate the Transceiver

- 1) Make sure the microphone is connected to the microphone jack.
- 2) Make sure the power cable is connected properly.
- 3) Make sure the antenna is connected to the antenna receptacle.
- 4) It is better to put the squelch control knob turned fully counter-clockwise.
- 5) Turn on the transceiver and control the volume level.
- 6) Adjust the squelch control knob to the optimum level.
- 7) Select your desired channel.
- 8) To transmit, press the PTT button and speak to the microphone.
- 9) Release the PTT button to receive.

7. Trouble shooting

If you experience problems with your TCB-900evo transceiver, first check the power supply source. Poor connection of the power supply source can cause problems such as no transmission, no reception or poor reception, and weak or no sound. Ensure that the microphone and antenna are also well connected.

If this does not solve the problem, reset your transceiver as follows.

- 1) Switch off the transceiver.
- 2) Pressing "9/19" button and turn on the transceiver.

This will reset the transceiver, so all the memories are erased and the parameters return to the initial factory setting. This should fix most problems.

In case of further difficulty, please consult your dealer or visit our website.

8. CE Declaration



CE versions of the TCB-900evo which display the CE symbol on the product label. Comply with the essential requirements of the Radio Equipment Directive (RED) 2014/53/EU.

This warning symbol indicates that this equipment operates in non-harmonized frequency bands and/or maybe subject to licensing conditions in the country of use.

Be sure to check that you have the correct version of this radio or the correct programming of this radio, to comply with your national licensing requirements.

This unit can be used without license and charges in; Austria, Belgium, Bulgaria, Cyprus, Czech, Denmark, Estonia, Finland, France, Germany, Greece, Hungary, Iceland, Ireland, Italy, Latvia, Lithuania, Luxembourg, Malta, Netherlands, Norway, Poland, Portugal, Romania, Slovakia, Slovenia, Spain, Sweden, Switzerland, and U.K.

9. Safety Requirement

The power cable is for 13.2 / 24V DC only. Be sure the transceiver is off before connection the leads of the power cable to the power supply. It is important to observe the polarity even if the unit is protected against the accidental inversion :

- * Red : Positive pole (+)
- * Black : Negative pole (-)

The same colors are present on the battery and in the fuse box of the car. The unit must be wired for the negative ground only. To avoid damage, do not operate your CB radio without connecting a proper antenna

10. Specifications

GENERAL	Channel	40 (See the frequency band chart)		
	Frequency Range	26.965 - 27.405 MHz		
	Operating mode	F3E (FM), A3E (AM)		
	Frequency Control	PLL Synthesizer		
	Frequency Tolerance	0.002%		
	Operating Temperature Range	-10 to +55 °C		
	Microphone	Plug-in Type		
	Input Voltage	13.2 / 24V DC ± 15%		
	Size	171 (W) x 95.6 (L) x 51 (H) without back heatsink		
	Weight	664 g		
Antenna Connector	SO-239 type			
TRANSMIT	Power Output	Duty cycle 10% 4 Watts @ 13.8V DC		
	Modulation	AM: from 85% to 95% FM: 1.8KHz ± 0.2KHz		
	Frequency Response	300Hz to 3000Hz		
	Output Impedance	50ohms, Unbalanced		
	Harmonic Suppression	Less than -36dBm		
Current Drain	AM Full Mod. 1.6A Max.			
RECEIVE	Receiving System	Dual conversion superheterodyne		
	IF Frequencies	Double conversion 1st 10.695MHz/2nd 455KHz		
	Sensitivity	0.7µV for 10dB(S+N)/N in AM Mode 0.7µV for 20dB SINAD in FM Mode		
	Audio Output Power	2W @ 8ohm		
	Audio Distortion	Less than 8% @ 1KHz		
	Image Rejection	More than 60dB		
	Adjacent Channel Rejection	More than 60dB		
	Conducted Spurious	Less than -57dBm		
	Frequency Response	300Hz to 2500Hz		
	Built-in Speaker	8ohms, Round		
Squelch	Adjustable; Threshold less than 1µV DSS; Less than 2µV			

* Specification is subject to change without prior notice.

11. Restrictions on the use

Country	Band	Use restrictions and other comments
BELGIUM SWITZERLAND	EU F EC	40 Ch - 4W FM - Individual licence is required 40 Ch - 4W AM - Individual licence is required
DENMARK,NORWAY LUXEMBOURG,CZECH	EC	40 Ch - 4W FM - Free use
FINLAND,PORTUGAL FRANCE,NETHERLANDS	EU F EC	40 Ch - 4W FM - Free use 40 Ch - 4W AM - Free use
GERMANY	D EU D2 EC	80 Ch - 4W FM - Individual licence is required 40 Ch - 4W AM - Individual licence is required 40 Ch - 4W AM - Use ch 4-15 only 40 Ch - 4W FM - Free use 12 Ch - 4W AM - Individual licence is required
		fx Allowed: from 26.960 to 27.410 MHz "BAPT 222 ZV 104"
GREECE	E EU F I EC	40 Ch - 4W FM - Free use 40 Ch - 4W AM - Free use
		T/R 20-02
IRELAND	E EU F I EC	40 Ch - 4W FM - Free use 40 Ch - 4W AM - Free use
		S.I. No 436 of 1998. WIRELESS TELEGRAPHY ACT, 1926 (SECTIONS) (EXEMPTION OF CITIZENS' BAND (CB) RADIOS) ORDER, 1998
ITALY	E EU F I EC I2	40 Ch - 4W FM - General authorization is required 40 Ch - 4W AM - General authorization is required 34 Ch - 4W FM 34 Ch - 4W AM(ERP) *AM mode allowed on ch1-23 only
		PNF issued on DM 08.07.02 NOTES 49 A-B-C-D-E-G
SPAIN	E EU F EC	40 Ch - 4W FM - Individual licence is required 40 Ch - 4W FM - Individual licence is required
		Art. 57 - Law 11/1998 dated 24th April
SWEDEN	EU F EC	40 Ch - 4W FM - Free use 40 Ch - 4W AM - Individual licence is required
UK	UK EU	40 Ch - 4W FM - Free use 40 Ch - 4W AM - Free use
POLAND	PL EU EC	40 Ch - 4W FM / AM - Free use

<< Declaration of Conformity >>

We, TTI Tech Co., Ltd. (#1312 361 Simindaero Dongan-gu Anyang-si Gyeonggi-do Korea) declare on our sole responsibility that this equipment complies with the essential requirements of the Radio Equipment Directive (RED) 2014/53/EU, and that any applicable Essential Test Suite measurements have been performed.

Kind of equipment : MOBILE CB TRANSCEIVER

Type-designation : TCB-900evo

Version (where applicable) :

This compliance is based on conformity with the following standards, specifications or documents :

EN 62311:2008
EN 50665:2017
EN 62368-1:2014+A11:2017
EN 301 489-1 V2.2.3:2019-11
EN 301 489-13 V1.2.1:2002-08
EN 300 433 V2.1.1 (2016-05)



N. Y. Kim
Director

Korea, Jan. 2022

Signature

STATIE RADIO CB TCB-900evo

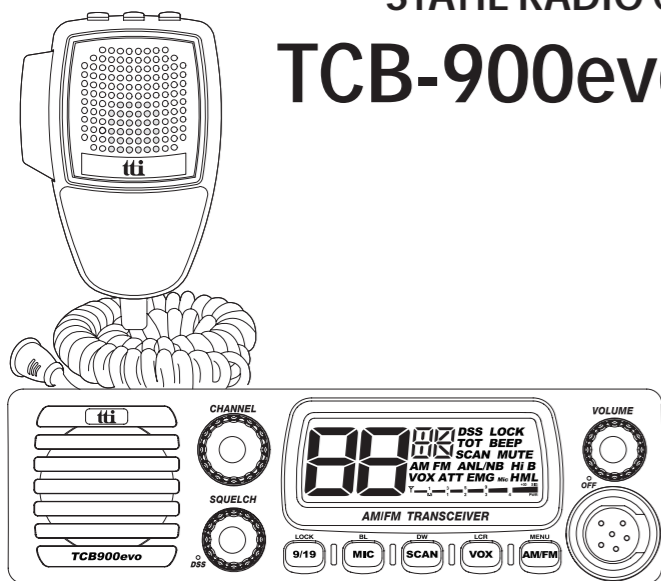

MANUAL DE UTILIZARE



www.ttikorea.co.kr

P/N 820-C900-E00

4. Taste si functii

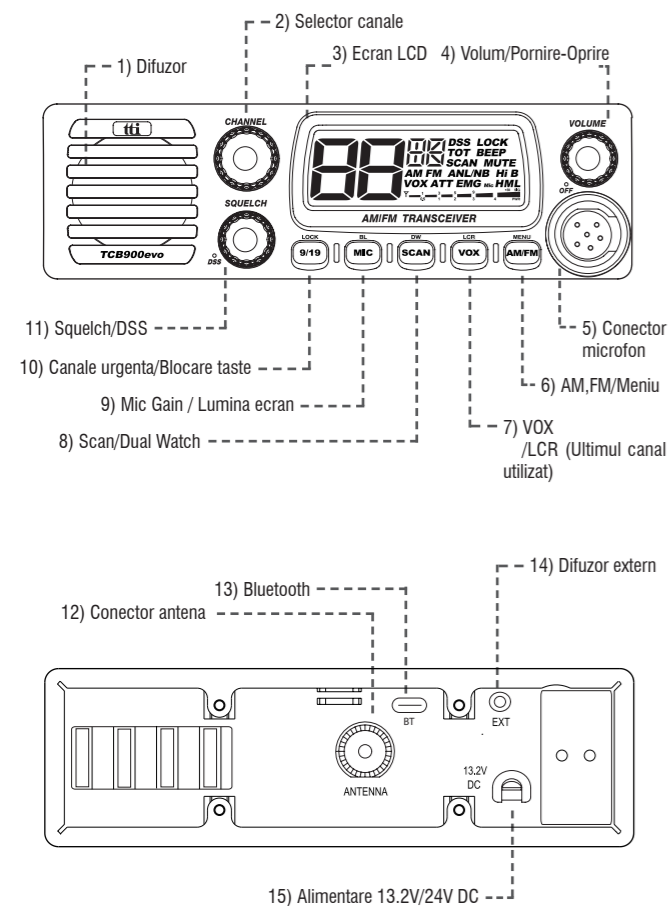

1. Accesorii incluse

Statia dumneavoastra CB este echipata cu o gama completa de accesorii care va ajuta sa puneti imediat statia in functiune.

Statie radio CB TCB-900evo	1 bucata
Microfon cu cablu	1 bucata
Cablu alimentare	1 bucata
Mufa de bricheta	1 bucata
Suport montaj statie	1 bucata
Suruburi cu saiba de cauciuc	2 bucati
Suruburi cu saiba (pentru suport statie)	3 bucati
Suruburi cu saiba (pentru suport microfon)	2 bucati
Suport microfon	1 bucata

2. Instalare

Instalarea cu suportul de montaj

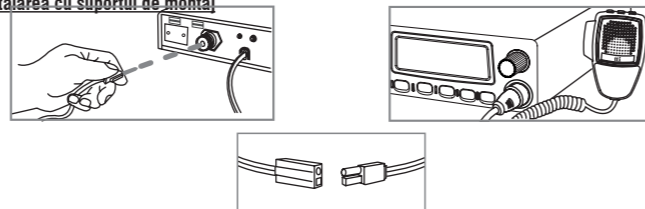

- 1) Instalati suportul statiei in locatia finala.
 - 2) Faceti gauri si instalati suportul.
 - 3) Conectati cablul antenei externe in conectorul de pe panoul din spate al statiei marcat cu simbolul "ANT".
 - 4) Conectati mufa de bricheta inclusa in conectorul dedicat din bordul masinii sau conectati cablul de alimentare al statiei direct la bateria vehiculului sau la cutia de sigurante a vehiculului. Respectati polaritatea (Rosu: pol pozitiv(+), Negru: Pol negativ(-). Aceleasi culori sunt marcate si pe baterie si in cutia cu sigurante a vehiculului.)
 - 5) Conectati cablul de alimentare la statie.
 - 6) Fixati suportul pentru microfon folosind suruburile incluse.
 - 7) Conectati microfonul la statie.
- Acum statia este pregatita pentru a fi pusa in functiune.

- 1) Difuzor frontal
- 2) Selector canale
Rotiti butonul spre stanga sau spre dreapta pentru a selecta canalul dorit.
- 3) Ecran LCD
- 4) Volum / Pornire-Oprire statie
- 5) Conector microfon
- 6) AM,FM / Meniu
Apasati scurt pentru a selecta modulatia AM / FM.
Apasati lung pentru a accesa meniul. Folositi selectorul de canale pentru a ajunge la optiunea din meniu dorita.
Pe microfon, apasati tasta centrala (VOX) pentru a accesa meniul. Folositi tastele SUS si JOS pentru a selecta optiunea din meniu dorita.

<MENU>

Ecran	Funcctie	Setare
bn	Selectie banda	Consultati tabelul cu benzile
bt	Selectie Bluetooth	On, Off
nb	Noise Blanker	On, Off
bP	Beep taste	On, Off
to	Time-out Timer	1-99 sec., Off
At	Atenuare	On, Off

Instalarea statiei in suport

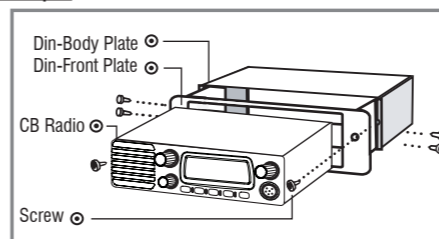

- 1) Instalati suportul DIN in locul dedicat din bordul masinii dvs. (Folositi clapetele de blocare furnizate.)
- 2) Introduceti statia in suportul DIN.
- 3) Fixati statia cu suruburile furnizate.

Instalare antena

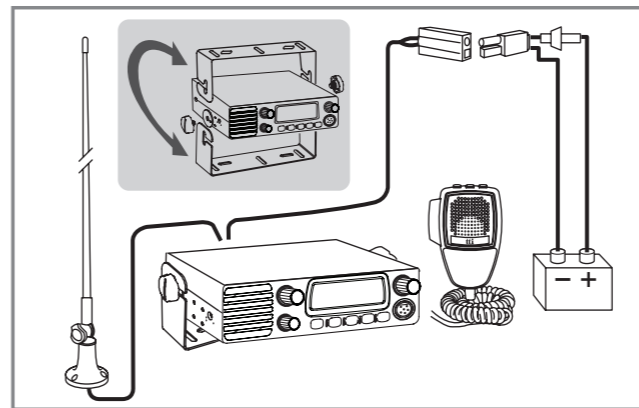

- 1) Instalati antena cat mai sus posibil pe cupola masinii.
- 2) Cu cat este mai lunga antena, cu atat sunt mai bune performantele sale.
- 3) Incercati sa montati antena pe centrul cupolei cu ajutorul unei baze magnetice. Verificati valoarea SWR a antenei.
- 4) Asigurati-va ca aveti o conexiune buna de masa metal-metal.
- 5) Aveti grija sa nu deteriorati cablul antenei in timpul instalarii.

Atentionare: Nu folositi statia si nu emiteti daca nu ati instalat mai intai antena CB.

<Tabel benzi>

Simbol	Pictograma	Setare
EC	EC	Europa 40ch. FM 4W
EU	EU	Europa 40ch. AM/FM 4W
D	d	Germania 80ch. FM 4W, 40ch. AM 4W
I2	i2	Italia 34ch. AM/FM 4W
I	i	Italia 40ch. AM/FM 4W
UE(EU/UK)	UE	UK 40ch. FM 4W (frecvente britanice) + CEPT 40ch. FM 4W(EC)
UK	UH	UK 40ch. FM 4W (frecvente britanice)
PL	PL	Polonia 40ch. AM/FM 4W (frecvente poloneze: 5KHz)
F	F	Franta 40ch. FM 4W, 40ch AM 4W
E	E	Spania 40ch. AM/FM 4W

7) Buton VOX / LCR
Apasati scurt pentru a activa functia VOX. Folosind functia Mic gain sensibilitatea VOX poate fi reglata. Apasati lung pentru a reveni la ultimul canal folosit.

8) Buton Scan / Dual Watch
Apasati scurt pentru a activa functia Scan.
Apasati lung pentru a activa functia Dual Watch. Canalul curent este canalul principal iar canalul secundar poate fi selectat cu ajutorul selectorului de canale.

9) Mic Gain / Lumina de fundal ecran
Apasati scurt pentru a schimba nivelul Mic Gain: ridicat (H), mediu (M) si scazut (L). Apasati lung pentru a schimba lumina de fundal a ecranului.

3. Ecran LCD

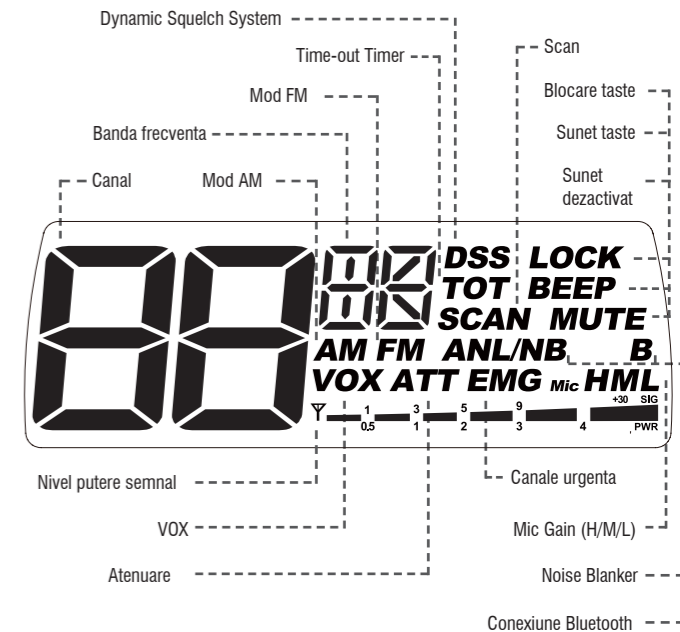

10) Buton 9/19 / Lock (blocare taste)
Apasati scurt pentru a selecta canalele de urgenta (9 sau 19).
Apasati lung pentru a bloca tastele. Tasta de volum, squelch si 9/19 raman active.

11) Squelch / DSS
Reglare manuala: Rotiti acest buton in sens invers acelor de ceasornic pana auziti zgomotul de fundal apoi rotiti usor in sensul acelor de ceasornic pana zgomotul dispare. Astfel, obtineti cea mai buna sensibilitate la receptie.
DSS : In modul FM rotiti butonul in sens invers acelor de ceasornic pana auziti un click. Nivelul de squelch este reglat dinamic.

12) Conector antena

13) Conector Dongle Bluetooth

14) Conector difuzor extern

15) Alimentare 13.2V / 24V DC

5. Microfon

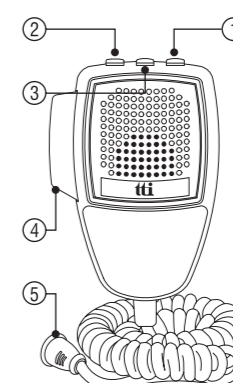

- 1) Tasta Sus
- 2) Tasta Jos
- 3) Mute / VOX
Mute (fara sunet): apasati butonul pentru a dezactiva difuzorul.
VOX : Apasati lung pentru a activa functia VOX.
- 4) Tasta PTT
- 5) Conector microfon 6 pini

6. Utilizarea statiei

- 1) Asigurati ca microfonul este conectat in statie.
- 2) Asigurati-va ca ati conectat corect cablul de alimentare.
- 3) Asigurati-va ca ati conectat la statie antena externa.
- 4) Rotiti butonul de control squelch complet spre stanga.
- 5) Porniti statia si reglati volumul.
- 6) Reglati squelch-ul la nivelul optim.
- 7) Selectati canalul dorit.
- 8) Pentru a emite, apasati tasta PTT si vorbiti inspre microfon.
- 9) Eliberati tasta PTT pentru a receptiona.

7. Probleme si solutii

Daca intampinati probleme cu statia dvs., mai intai verificati alimentarea. O alimentare defectuoasa poate cauza probleme de functionare a statiei, cum ar fi lipsa receptie sau receptie slaba, lipsa sunet sau sunet slab. De asemenea, asigurati-va ca ati conectat corect antena si microfonul. Daca problema persista, resetati statia dupa cum urmeaza.

- 1) Opriti staia.
- 2) Tineti apasat butonul "9/19" in timp ce pornti statia.

Aceasta procedura va reseta statia, astfel toti parametrii vor reveni la setarile din fabrica. Aceasta procedura ar trebui sa rezolve majoritatea problemelor de functionare. Daca problema persista, apelati la un centru service specializat.

8. Declaratie de conformitate CE



TCB-900evo afiseaza simbolul CE pe eticheta de pe produs, Produsul este conform cu cerintele Directivei RED 2014/53/EU. Acest simbol de avertizare indica faptul ca acest echipament functioneaza in benzi de frecventa nearmonizate si/sau poate fi supus conditiilor de licenta in tara de utilizare. Asigurati-va ca ati programat corect statia CB, pentru a respecta cerintele nationale de licentiere.

Aceasta statie poate fi utilizata fara licenta in urmatoarele tari: Austria, Belgia, Bulgaria, Cipru, Cehia, Danemarca, Estonia, Finlanda, Franta, Germania, Grecia, Ungaria, Islanda, Irlanda, Italia, Letonia, Lituania, Luxemburg, Malta, Tarile de Jos, Norvegia, Polonia, Portugalia, Romania, Slovacia, Slovenia, Spania, Suedia, Elvetia si U.K.

9. Cerinte de siguranta

Alimentati statia la 13.2 / 24V DC. Inainte de alimentarea statiei, asigurati-va ca statia este inchisa. Cand faceti conexiunile respectati polaritatea chiar daca statia are o siguranta de protectie in caz de polaritate inversata:

- * Rosu : Pol pozitiv (+)
- * Negru : Pol negativ (-)

Aceiasi culori sunt indicate pe baterie si pe cutia de sigurante. Nu folositi statia fara sa aveti o antena externa conectata.

10. Specificatii tehnice

GENERAL	
Canal	40 (vezi tabel benzi)
Interval frecventa	26.965 - 27.405 MHz
Mod operare	F3E (FM), A3E (AM)
Control frecventa	PLL Synthesizer
Toleranta frecventa	0.002%
Interval temperatura	-10 to +55 °C
Microfon	Plug-in Type
Tensiune alimentare	13.2 / 24V DC ± 15%
Dimensiuni	171 (W) x 95.6 (L) x 51 (H) without back heatsink
Greutate	664 g
Conector antena	SO-239 type
EMISIE	
Putere de emisie	Duty cycle 10% 4 Watts @ 13.8V DC
Modulatie	AM: de la 85% la 95% FM: 1.8KHz ± 0.2KHz
Raspuns frecventa	300Hz to 3000Hz
Impedanta	50ohms, Unbalanced
Supresie armonica	< -36dBm
Consum	AM Full Mod. 1.6A Max.
RECEPTIE	
Sistem receptie	Conversie dubla superheterodina
Frecvente IF	conversie dubla 1st 10.695MHz/2nd 455KHz
Sensibilitate	0.7µV pentru 10dB(S+N)/N in mod AM 0.7µV pentru 20dB SINAD in mod FM
Putere audio	2W @ 8ohm
Distorsiune audio	Less than 8% @ 1KHz
Respingere imagine	> 60dB
Respingere canal adiacent	> 60dB
Emisii de zgomot de fond	< -57dBm
Raspuns frecventa	300Hz to 2500Hz
Difuzor incorporat	8ohms, Round
Squelch	Reglabil; Prag mai mic de 1µV DSS; < 2µV

* Specificatiile pot fi modificate fara notificare prealabila.

11. Restrictii de utilizare

Tara	Banda	Restructii si alte comentarii
BELGIA ELVETIA	EU F EC	40 Ch - 4W FM - Necesita licenta individuala 40 Ch - 4W AM - Necesita licenta individuala
DANEMARCA, NORVEGIA LUXEMBURG, CEHIA	EC	40 Ch - 4W FM - Utilizare libera
FINLANDA, PORTUGALIA FRANTA, TARILE DE JOS	EU F EC	40 Ch - 4W FM - Utilizare libera 40 Ch - 4W AM - Utilizare libera
GERMANIA	D EU D2 EC	80 Ch - 4W FM - Necesita licenta individuala 40 Ch - 4W AM - Necesita licenta individuala 40 Ch - 4W AM - Se pot folosi doar canalele 4-15 40 Ch - 4W FM - Utilizare libera 12 Ch - 4W AM - Necesita licenta individuala
	fx Permis: de la 26.960 la 27.410 MHz "BAPT 222 ZV 104"	
GRECIA	E EU F I EC	40 Ch - 4W FM - Utilizare libera 40 Ch - 4W AM - Utilizare libera
	T/R 20-02	
IRLANDA	E EU F I EC	40 Ch - 4W FM - Utilizare libera 40 Ch - 4W AM - Utilizare libera
	S.I. No 436 of 1998. WIRELESS TELEGRAPHY ACT, 1926 (SECTIUNI) (EXEMPTION OF CITIZENS' BAND (CB) RADIOS) ORDER, 1998	
ITALIA	E EU F I EC I2	40 Ch - 4W FM - Necesita autorizare generala 40 Ch - 4W AM - Necesita autorizare generala 34 Ch - 4W FM 34 Ch - 4W AM(ERP) *AM mode allowed on ch1-23 only
	PNF emis la DM 08.07.02 NOTES 49 A-B-C-D-E-G	
SPANIA	E EU F EC	40 Ch - 4W FM - Necesita licenta individuala 40 Ch - 4W FM - Necesita licenta individuala
	Art. 57 - LEGEA 11/1998 DIN 24 Aprilie	
SUEDIA	EU F EC	40 Ch - 4W FM - Utilizare libera 40 Ch - 4W AM - Necesita licenta individuala
UK	UK EU EC	40 Ch - 4W FM - Utilizare libera 40 Ch - 4W AM - Utilizare libera
POLONIA	PL EU EC	40 Ch - 4W FM / AM - Utilizare libera

<< DECLARATIE DE CONFORMITATE >>

Noi, TTI Tech Co., Ltd. (#1312 361 Simindaero Dongan-gu Anyang-si Gyeonggi-do Korea) declaram pe propria raspundere ca acest echipament este conform cu cerintele esentiale ale Directivei RED 2014/53/EU si ca au fost efectuate toate masuratorile necesare.

Tip echipament : Statie CB mobila

Model : TCB-900evo

Versiune (unde se aplica) :

Aceasta conformitate se bazeaza pe respectarea urmatoarelor standarde, specificatii sau documente:

EN 62311:2008
EN 50665:2017
EN 62368-1:2014+A11:2017
EN 301 489-1 V2.2.3:2019-11
EN 301 489-13 V1.2.1:2002-08
EN 300 433 V2.1.1 (2016-05)

N. Y. Kim

Director



Korea, Jan. 2022

Semnatura